

FISHER

FISHER MANUFACTURING COMPANY TOLL FREE: 800-421-6162 - FAX: 800-832-8238
customer@fisherfaucets.com - www.fisherfaucets.com

PRODUCT NAME:

REEL RINSE WHITE CVD CEILING 30 FT US

SPEC. RRCL-CKT-XX

Customer/Wholesaler:	Date:	Job Name:	Model Specified: 81345	Quantity:
Contractor:	Architect/Engineer:			

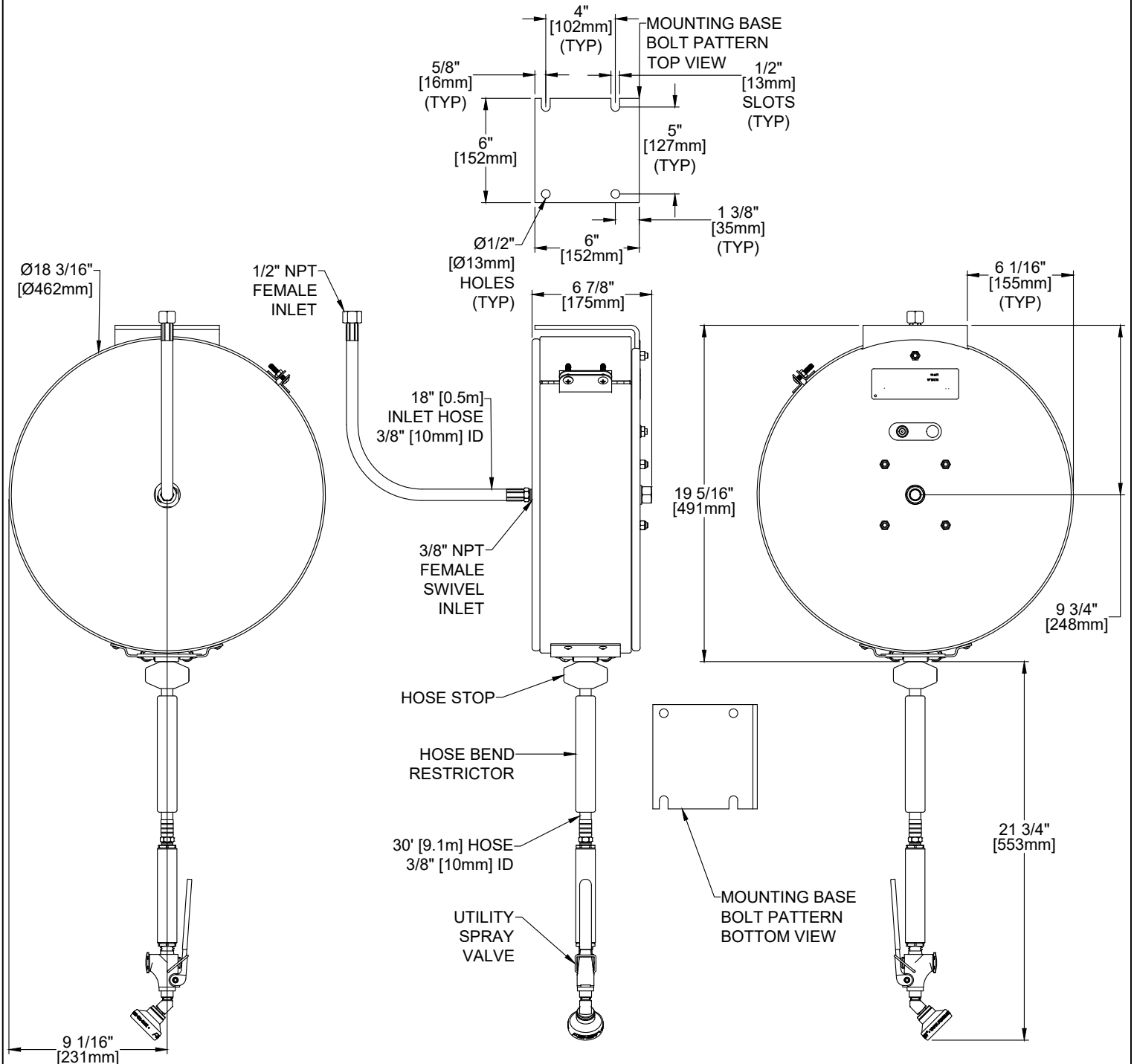

PRODUCT SPECIFICATIONS: CAFE REEL RINSE, COVERED WHITE POWDER COATED STEEL, CEILING MOUNT, 30' HOSE X 3/8" ID, 2.65 GPM @ 80 PSI UTILITY SPRAY VALVE, 18" INLET HOSE X 3/8" ID, 1/2" NPT FEMALE INLET

PRODUCT COMPLIANCE:
NSF 61 EXEMPT:
(NON-POTABLE)
2019 DOE PRSV:
NON-COMPLIANT

Drawn: LC	Checked: EM	Approved: LC	Date: 05/20/25	Sheet: 1 of 2
-----------	-------------	--------------	----------------	---------------



FISHER MANUFACTURING COMPANY TOLL FREE: 800-421-6162 - FAX: 800-832-8238
customer@fisherfaucets.com - www.fisherfaucets.com

PRODUCT NAME:

REEL RINSE WHITE CVD CEILING 30 FT US

Customer/Wholesaler:	Date:	Job Name:	Model Specified: 81345	Quantity:
Contractor:	Architect/Engineer:			

SPEC. RRCL-CKT-XX

REPLACEMENT PARTS

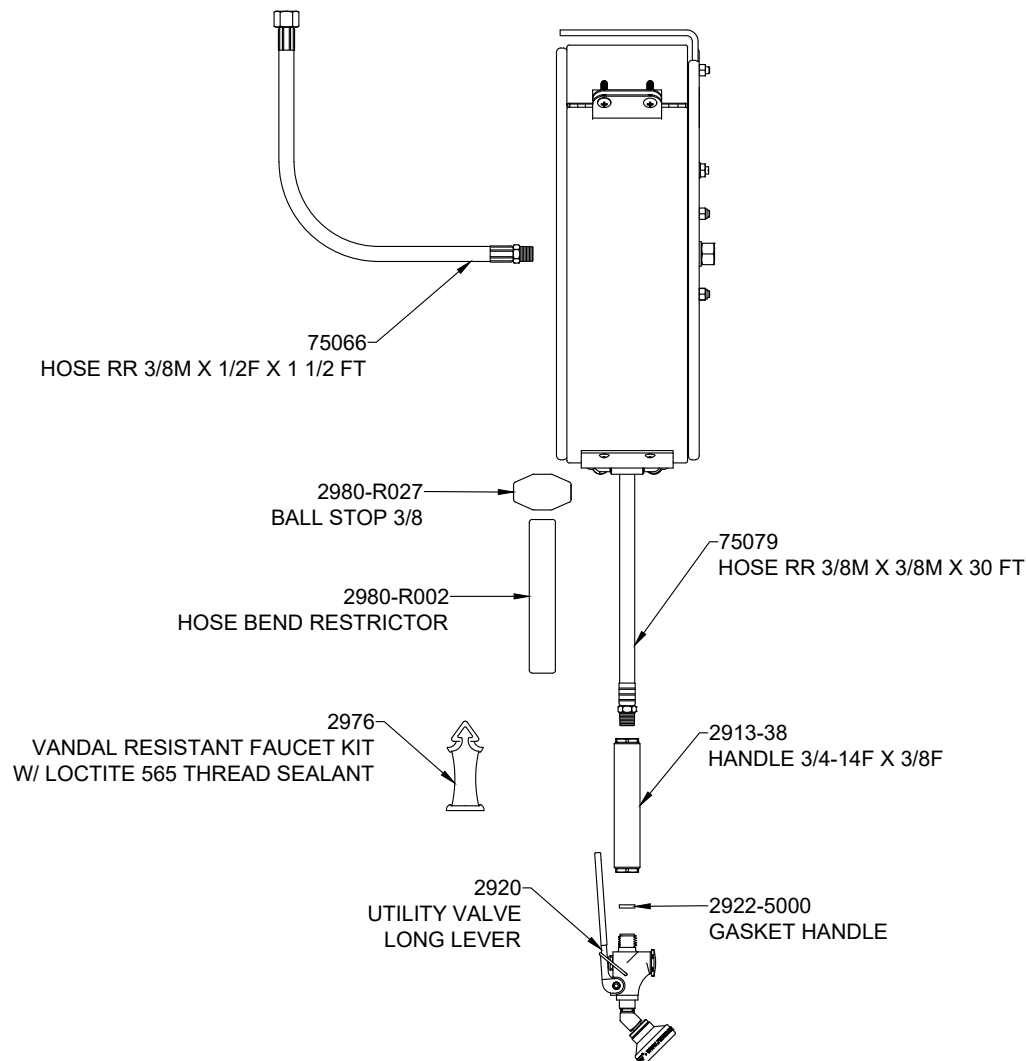

PRODUCT SPECIFICATIONS: CAFE REEL RINSE, COVERED WHITE POWDER COATED STEEL, CEILING MOUNT, 30' HOSE X 3/8" ID, 2.65 GPM @ 80 PSI UTILITY SPRAY VALVE, 18" INLET HOSE X 3/8" ID, 1/2" NPT FEMALE INLET

PRODUCT COMPLIANCE:
NSF 61 EXEMPT:
(NON-POTABLE)
2019 DOE PRSV:
NON-COMPLIANT

Drawn: LC	Checked: EM	Approved: LC	Date: 05/20/25	Sheet: 2 of 2
-----------	-------------	--------------	----------------	---------------