



FISHER MANUFACTURING COMPANY TOLL FREE: 800-421-6162 - FAX: 800-832-8238  
 customer@fisherfaucets.com - www.fisherfaucets.com

PRODUCT NAME:

SS PRERINSE SPG

SPEC. PRHS-SP-XX

Customer/Wholesaler:	Date:	Job Name:	Model Specified:	Quantity:
Contractor:		Architect/Engineer:		

	MODEL	DESCRIPTION	RISER SIZE	FLOW RATE
<input type="checkbox"/>	32697	SS PRERINSE SPG	16"	1.15 GPM
<input type="checkbox"/>	38660	SS PRERINSE SPG	21"	1.15 GPM
<input type="checkbox"/>	75597	SS PRERINSE SPG	21"	0.7 GPM
<input type="checkbox"/>	75596	SS PRERINSE SPG	16"	0.7 GPM

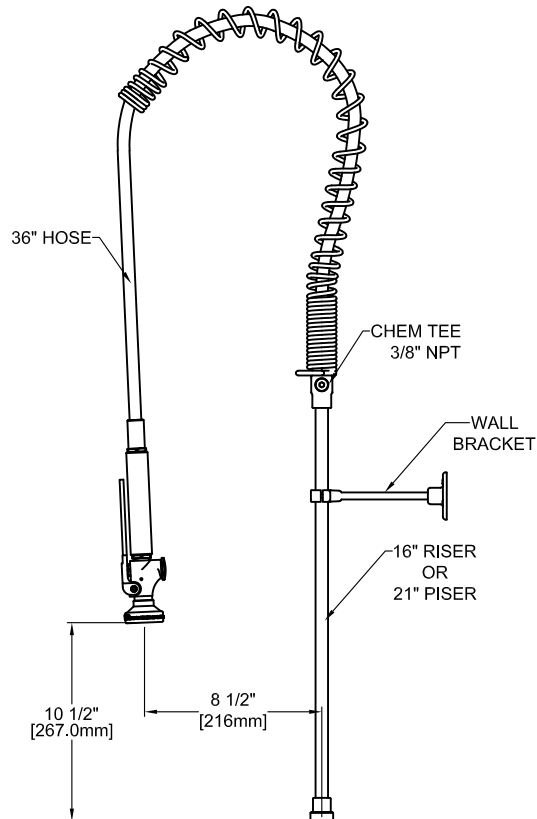
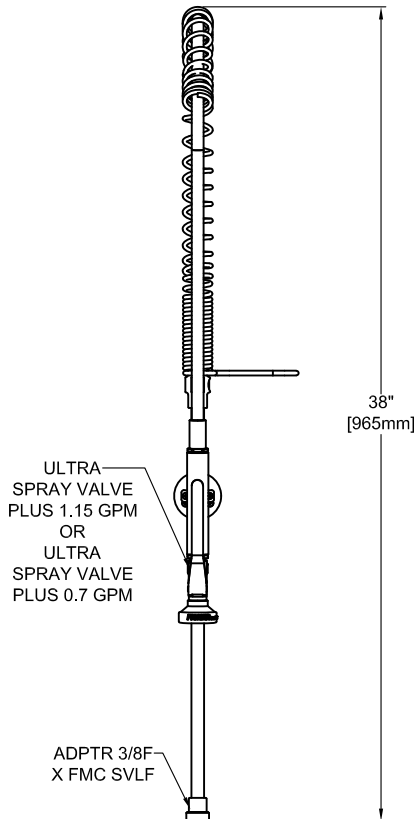
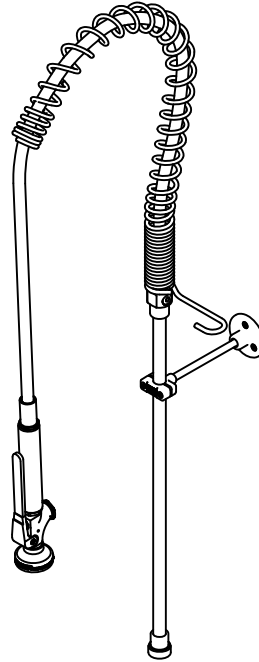
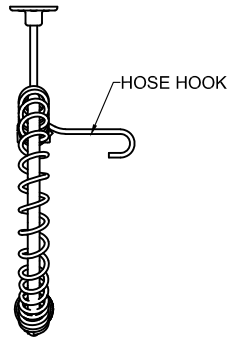

**PRODUCT SPECIFICATIONS:**  
 SS PRE-RINSE SPRING UNIT: 36" FLEXIBLE STAINLESS STEEL HOSE, 0.70 OR 1.15 GPM SPRAY VALVE, 16" OR 21" RISER, 12" WALL BRACKET, ADPTR 3/8F X FMC SVLF

**PRODUCT COMPLIANCE:**  
 ASME A112.18.1 / CSA B125.1  
 NSF 61 - Section 9  
 NSF 372 (Low Lead Content)  
 2019 DOE PRSV - Class II

Customer/Wholesaler:	Date:	Job Name:	Model Specified:	Quantity:
Contractor:		Architect/Engineer:		

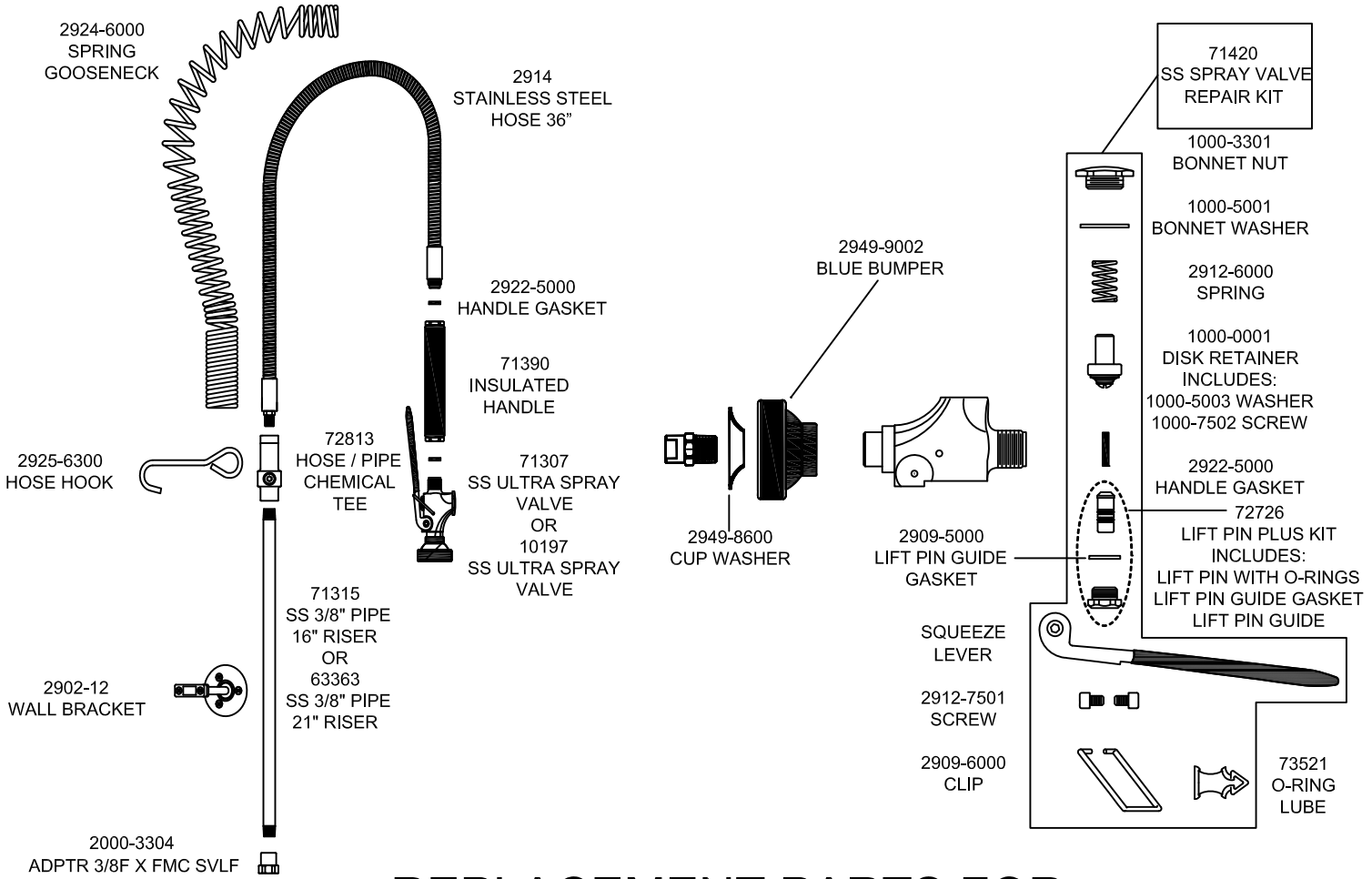

## REPLACEMENT PARTS FOR PRE-RINSE SPRING UNITS

<b>PRODUCT SPECIFICATIONS:</b> SS PRE-RINSE SPRING UNIT: 36" FLEXIBLE STAINLESS STEEL HOSE, 0.70 OR 1.15 GPM SPRAY VALVE, 16" OR 21" RISER, 12" WALL BRACKET, ADPTR 3/8F X FMC SVLF			<b>PRODUCT COMPLIANCE:</b> ASME A112.18.1 / CSA B125.1 NSF 61 - Section 9 NSF 372 (Low Lead Content) 2019 DOE PRSV - Class II	
Drawn: DF	Checked: EM	Approved: DF	Date: 02/28/24	Sheet: 2 of 2