

Customer/Wholesaler:	Date:	Job Name:	Model Specified: 90450	Quantity:
Contractor:		Architect/Engineer:		

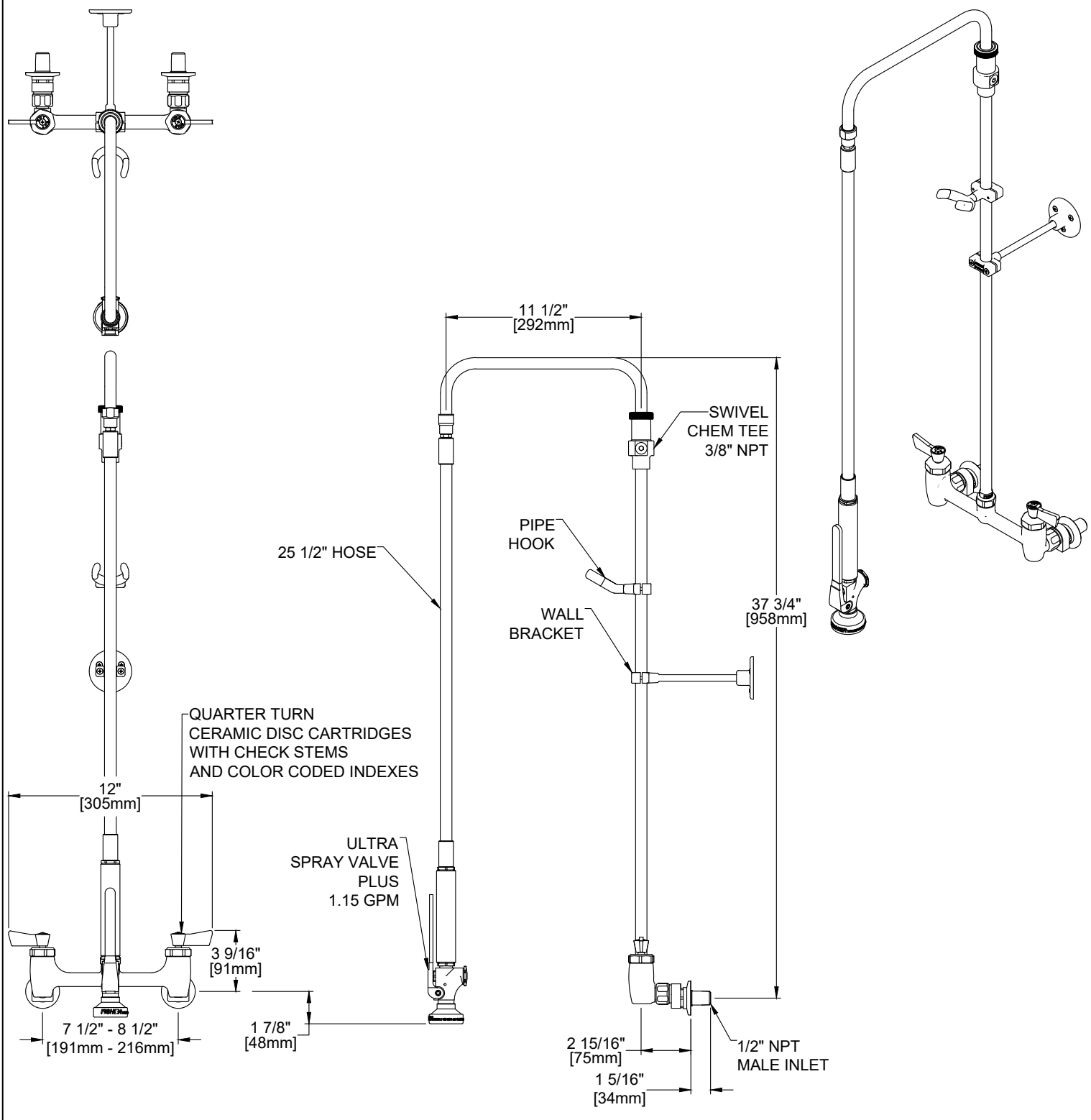

PRODUCT SPECIFICATIONS: PRE-RINSE UNIT: SWIVEL, 8" ADJUSTABLE BACKSPASH MOUNT MIXING FAUCET, QUARTER TURN CERAMIC DISC CARTRIDGES W/CHECK STEMS, LEVER HANDLES, 25 1/2" FLEXIBLE STAINLESS STEEL HOSE, 1.15 GPM SPRAY VALVE, 12" WALL BRACKET, 1/2" NPT MALE INLETS		PRODUCT COMPLIANCE: ASME A112.18.1 / CSA B125.1 NSF 61 - Section 9 NSF 372 (Low Lead Content) 2019 DOE PRSV - Class II	
Drawn: LC	Checked: EM	Approved: LC	Date: 02/26/24
Sheet:			1 of 2

Customer/Wholesaler:	Date:	Job Name:	Model Specified: 90450	Quantity:
Contractor:		Architect/Engineer:		

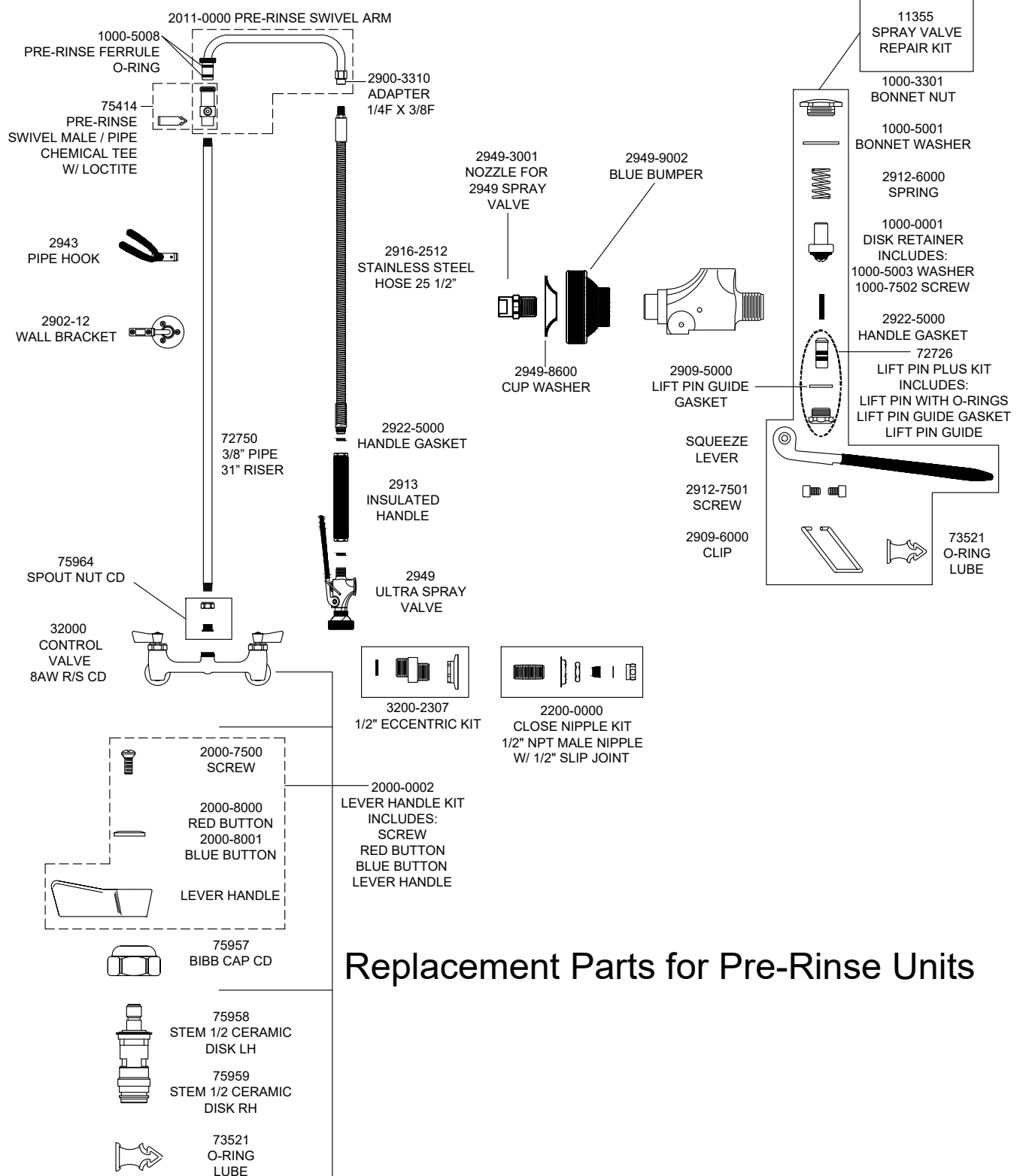

Replacement Parts for Pre-Rinse Units

PRODUCT SPECIFICATIONS: PRE-RINSE UNIT: SWIVEL, 8" ADJUSTABLE BACKSPASH MOUNT MIXING FAUCET, QUARTER TURN CERAMIC DISC CARTRIDGES W/CHECK STEMS, LEVER HANDLES, 25 1/2" FLEXIBLE STAINLESS STEEL HOSE, 1.15 GPM SPRAY VALVE, 12" WALL BRACKET, 1/2" NPT MALE INLETS		PRODUCT COMPLIANCE: ASME A112.18.1 / CSA B125.1 NSF 61 - Section 9 NSF 372 (Low Lead Content) 2019 DOE PRSV - Class II	
Drawn: LC	Checked: EM	Approved: LC	Date: 02/26/24
Sheet:			2 of 2