



FISHER MANUFACTURING COMPANY TOLL FREE: 800-421-6162 - FAX: 800-832-8238  
customer@fisherfaucets.com - www.fisherfaucets.com

PRODUCT NAME:

PRERINSE SPG SDDCDLH 00SS

SPEC. PRCB-SPA-SDDL

Customer/Wholesaler:	Date:	Job Name:	Model Specified:	Quantity:
Contractor:		Architect/Engineer:		

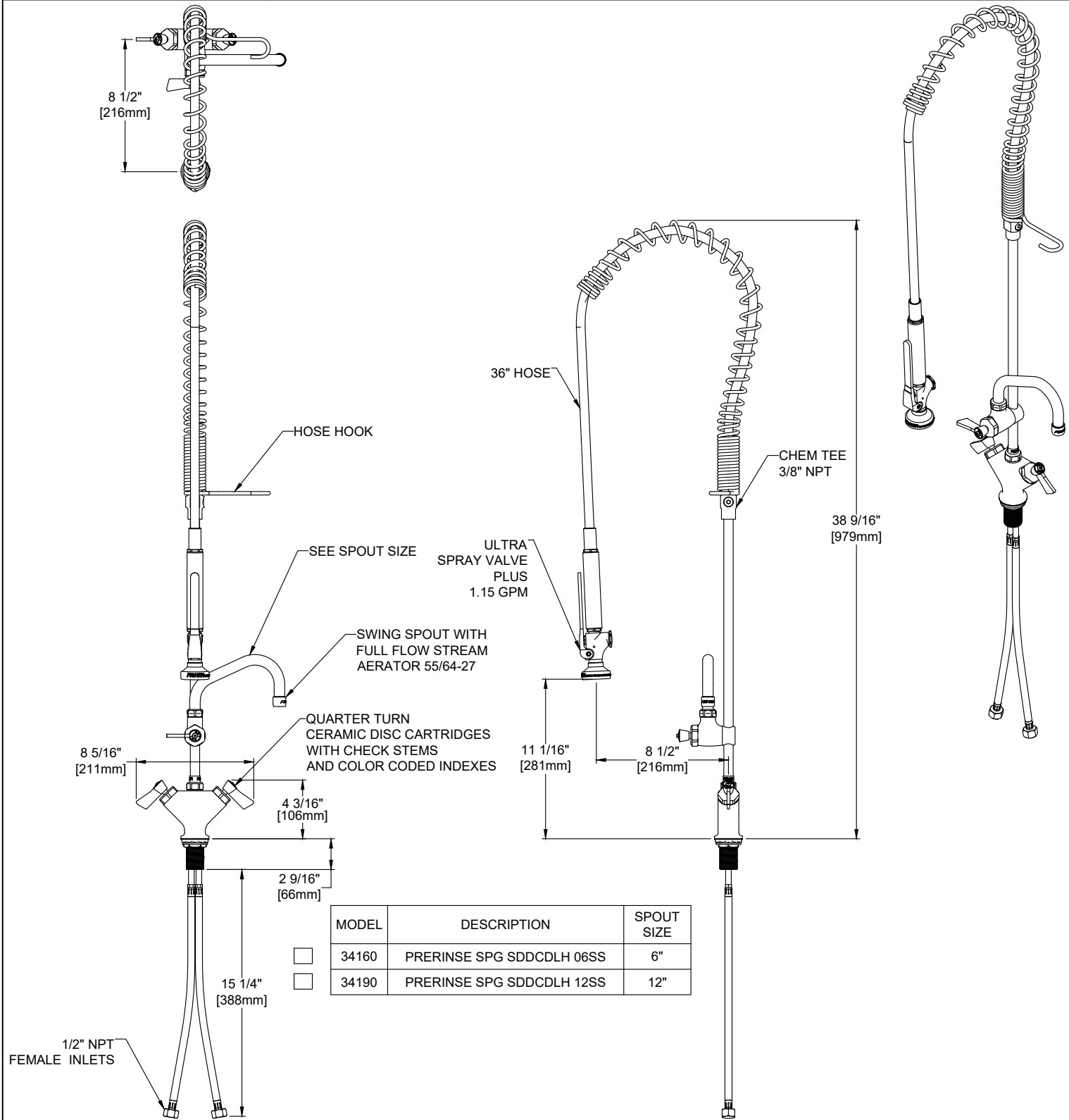

MODEL	DESCRIPTION	SPOUT SIZE
34160	PRERINSE SPG SDDCDLH 06SS	6"
34190	PRERINSE SPG SDDCDLH 12SS	12"

<b>PRODUCT SPECIFICATIONS:</b> PRE-RINSE UNIT: SINGLE DECK DUAL CONTROL MOUNT MIXING FAUCET, QUARTER TURN CERAMIC DISC CARTRIDGES W/CHECK STEMS, LEVER HANDLES, ADD-ON FAUCET W/ SWING SPOUT 36" FLEXIBLE STAINLESS STEEL HOSE, 1.15 GPM SPRAY VALVE, 12" WALL BRACKET, 1/2" NPT FEMALE INLETS		<b>PRODUCT COMPLIANCE:</b> ASME A112.18.1 / CSA B125.1 NSF 61 - Section 9 NSF 372 (Low Lead Content) 2019 DOE PRSV - Class II	
Drawn: LC	Checked: EM	Approved: LC	Date: 02/20/24
Sheet:			1 of 2

Customer/Wholesaler:	Date:	Job Name:	Model Specified:	Quantity:
Contractor:		Architect/Engineer:		

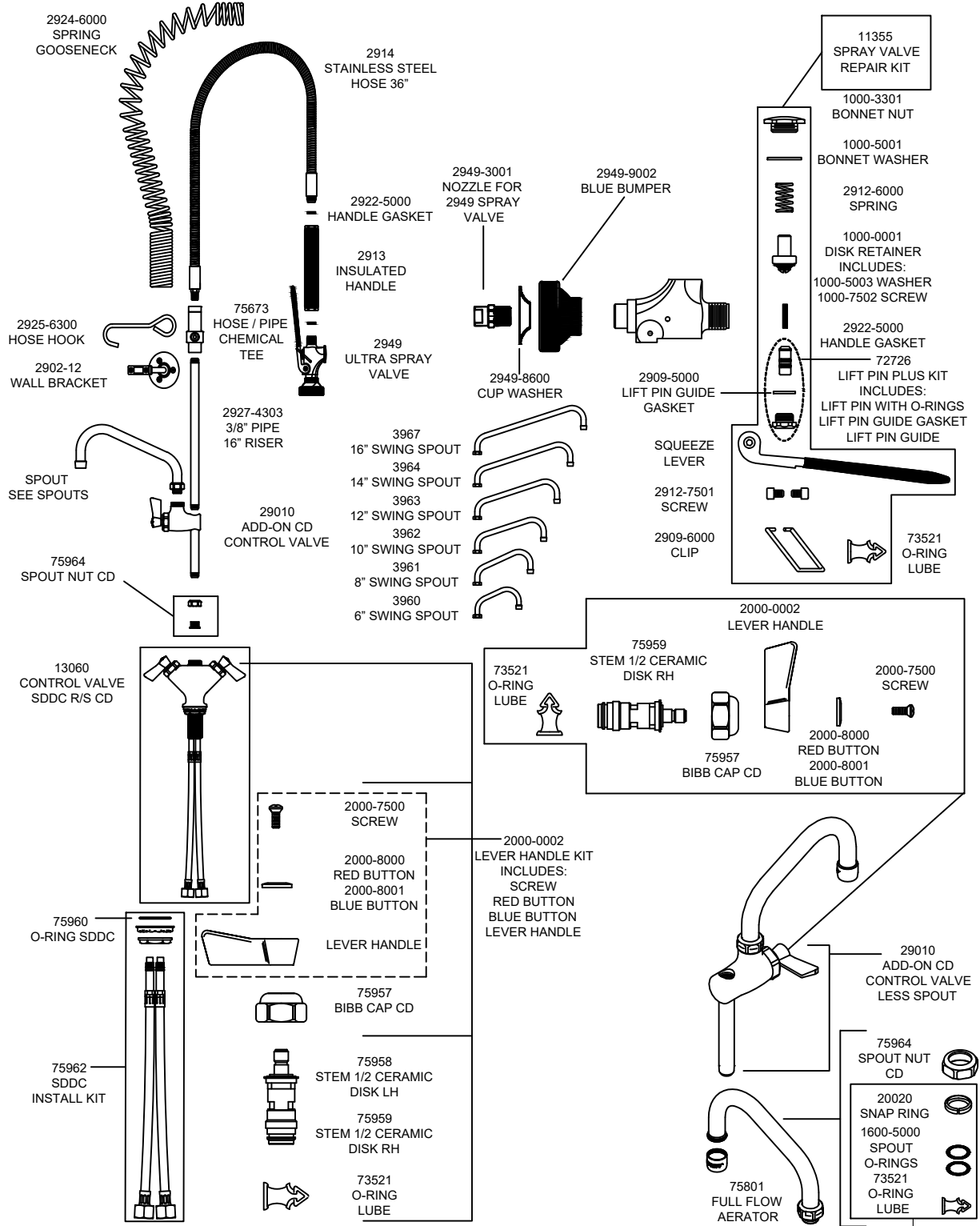

## Replacement Parts for Pre-Rinse Units

**PRODUCT SPECIFICATIONS:**

PRE-RINSE UNIT: SINGLE DECK DUAL CONTROL MOUNT MIXING FAUCET, QUARTER TURN CERAMIC DISK CARTRIDGES W/CHECK STEMS, LEVER HANDLES, ADD-ON FAUCET W/ SWING SPOUT 36" FLEXIBLE STAINLESS STEEL HOSE, 1.15 GPM SPRAY VALVE, 12" WALL BRACKET, 1/2" NPT FEMALE INLETS

**PRODUCT COMPLIANCE:**

ASME A112.18.1 / CSA B125.1  
NSF 61 - Section 9  
NSF 372 (Low Lead Content)  
2019 DOE PRSV - Class II

Drawn: LC	Checked: EM	Approved: LC	Date: 02/20/24	Sheet: 2 of 2
-----------	-------------	--------------	----------------	---------------