

Customer/Wholesaler:	Date:	Job Name:	Model Specified:	Quantity:
Contractor:		Architect/Engineer:		

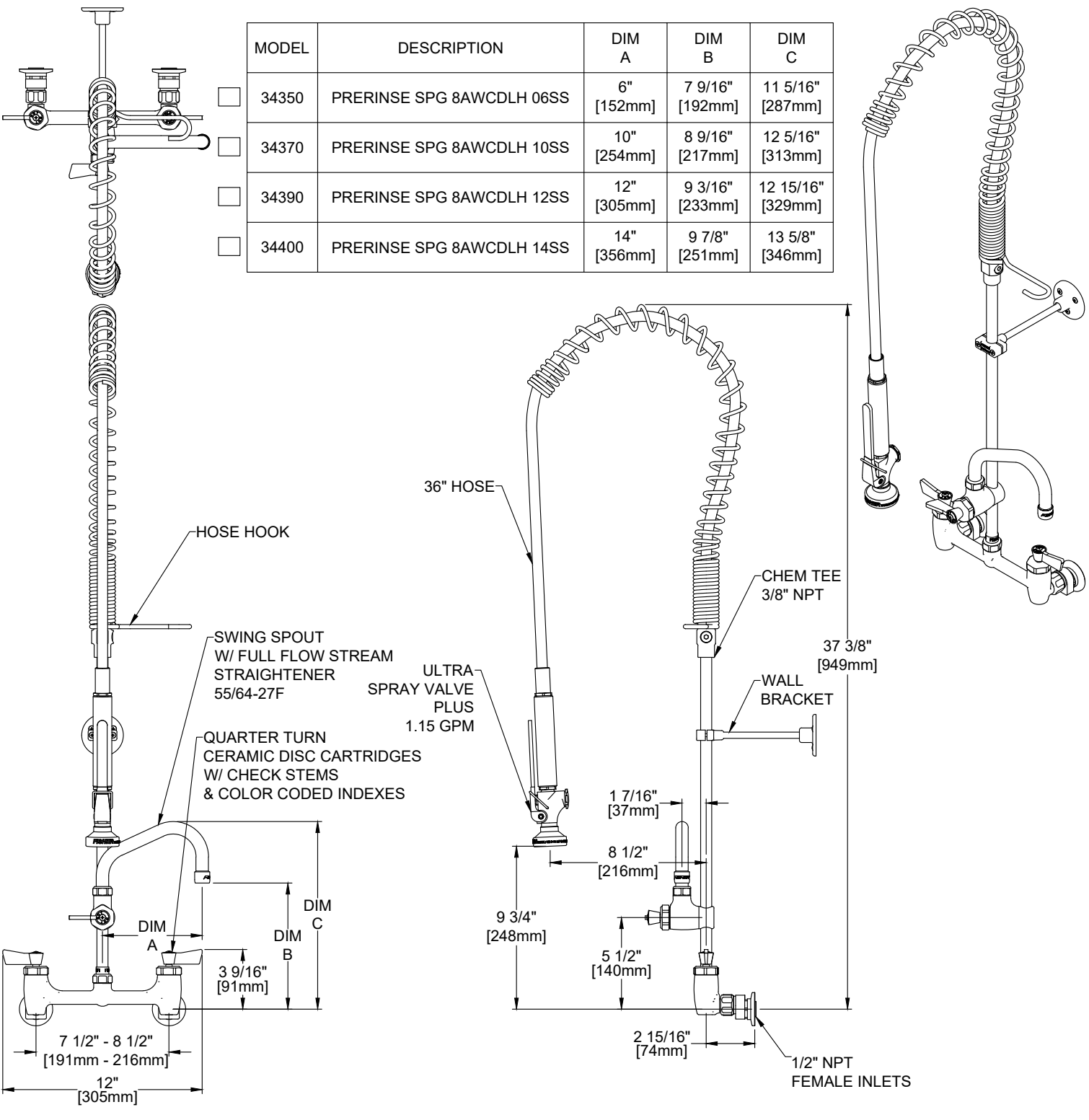

MODEL	DESCRIPTION	DIM A	DIM B	DIM C
<input type="checkbox"/> 34350	PRERINSE SPG 8AWCDLH 06SS	6" [152mm]	7 9/16" [192mm]	11 5/16" [287mm]
<input type="checkbox"/> 34370	PRERINSE SPG 8AWCDLH 10SS	10" [254mm]	8 9/16" [217mm]	12 5/16" [313mm]
<input type="checkbox"/> 34390	PRERINSE SPG 8AWCDLH 12SS	12" [305mm]	9 3/16" [233mm]	12 15/16" [329mm]
<input type="checkbox"/> 34400	PRERINSE SPG 8AWCDLH 14SS	14" [356mm]	9 7/8" [251mm]	13 5/8" [346mm]

<p><b>PRODUCT SPECIFICATIONS:</b>          PRE-RINSE UNIT: 8" ADJUSTABLE WALL MOUNT MIXING FAUCET, QUARTER TURN CERAMIC DISC CARTRIDGES W/ CHECK STEMS, LEVER HANDLES, ADD-ON FAUCET, SWING SPOUT W/ FULL FLOW STREAM STRAIGHTENER, 36" FLEXIBLE STAINLESS STEEL HOSE, 1.15 GPM SPRAY VALVE, 12" WALL BRACKET, 1/2" NPT FEMALE INLETS</p>	<p><b>PRODUCT COMPLIANCE:</b>          ASME A112.18.1 / CSA B125.1          NSF 61 - Section 9          NSF 372 (Low Lead Content)          2019 DOE PRSV - Class II</p>
---	--

Customer/Wholesaler:	Date:	Job Name:	Model Specified:	Quantity:
Contractor:		Architect/Engineer:		

## REPLACEMENT PARTS FOR PRE-RINSE UNITS

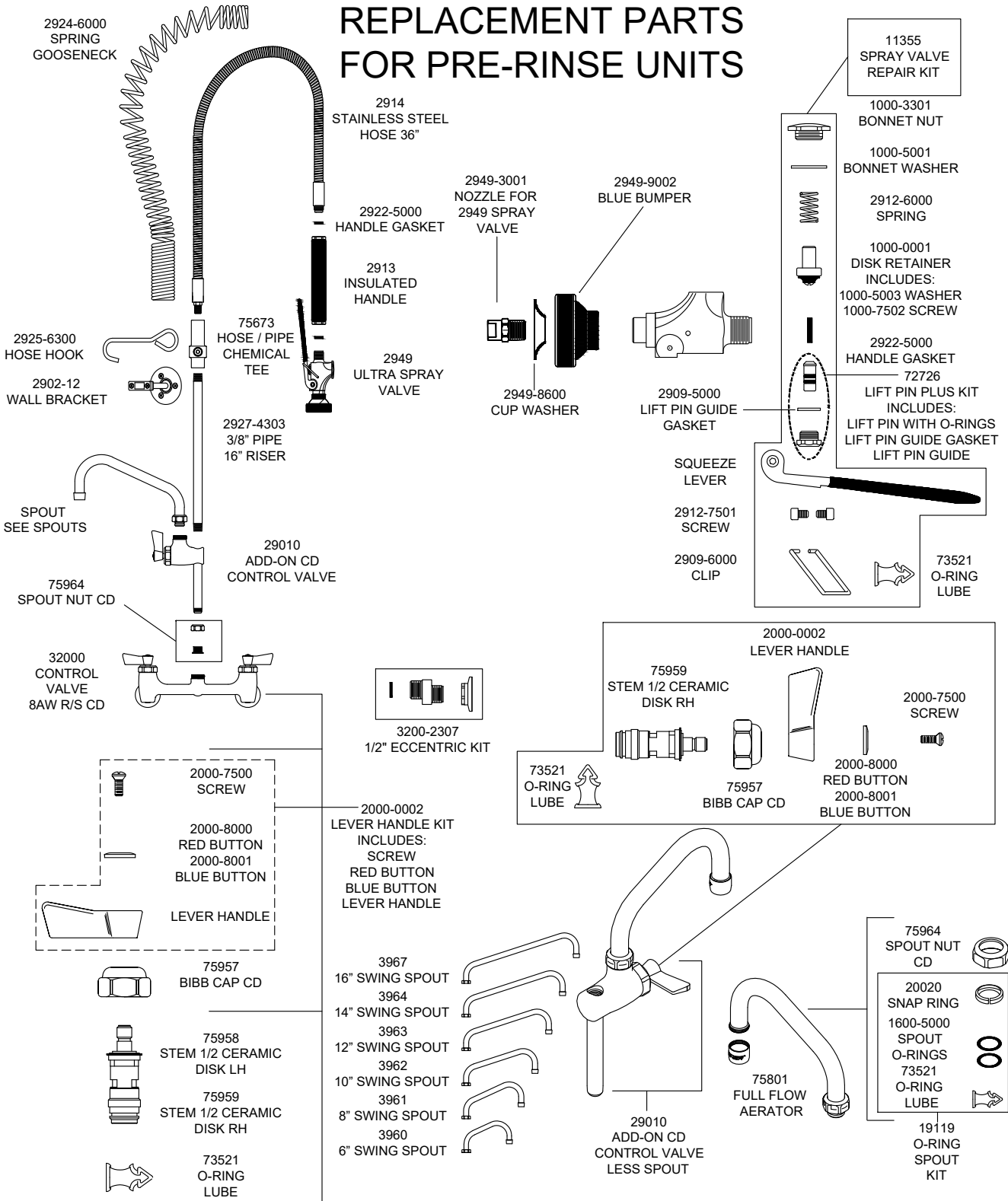

**PRODUCT SPECIFICATIONS:**  
 PRE-RINSE UNIT: 8" ADJUSTABLE WALL MOUNT MIXING FAUCET, QUARTER TURN CERAMIC DISC CARTRIDGES W/ CHECK STEMS, LEVER HANDLES, ADD-ON FAUCET, SWING SPOUT W/ FULL FLOW STREAM STRAIGHTENER, 36" FLEXIBLE STAINLESS STEEL HOSE, 1.15 GPM SPRAY VALVE, 12" WALL BRACKET, 1/2" NPT FEMALE INLETS

**PRODUCT COMPLIANCE:**  
 ASME A112.18.1 / CSA B125.1  
 NSF 61 - Section 9  
 NSF 372 (Low Lead Content)  
 2019 DOE PRSV - Class II