

Customer/Wholesaler:	Date:	Job Name:	Model Specified: 27100	Quantity:
Contractor:		Architect/Engineer:		

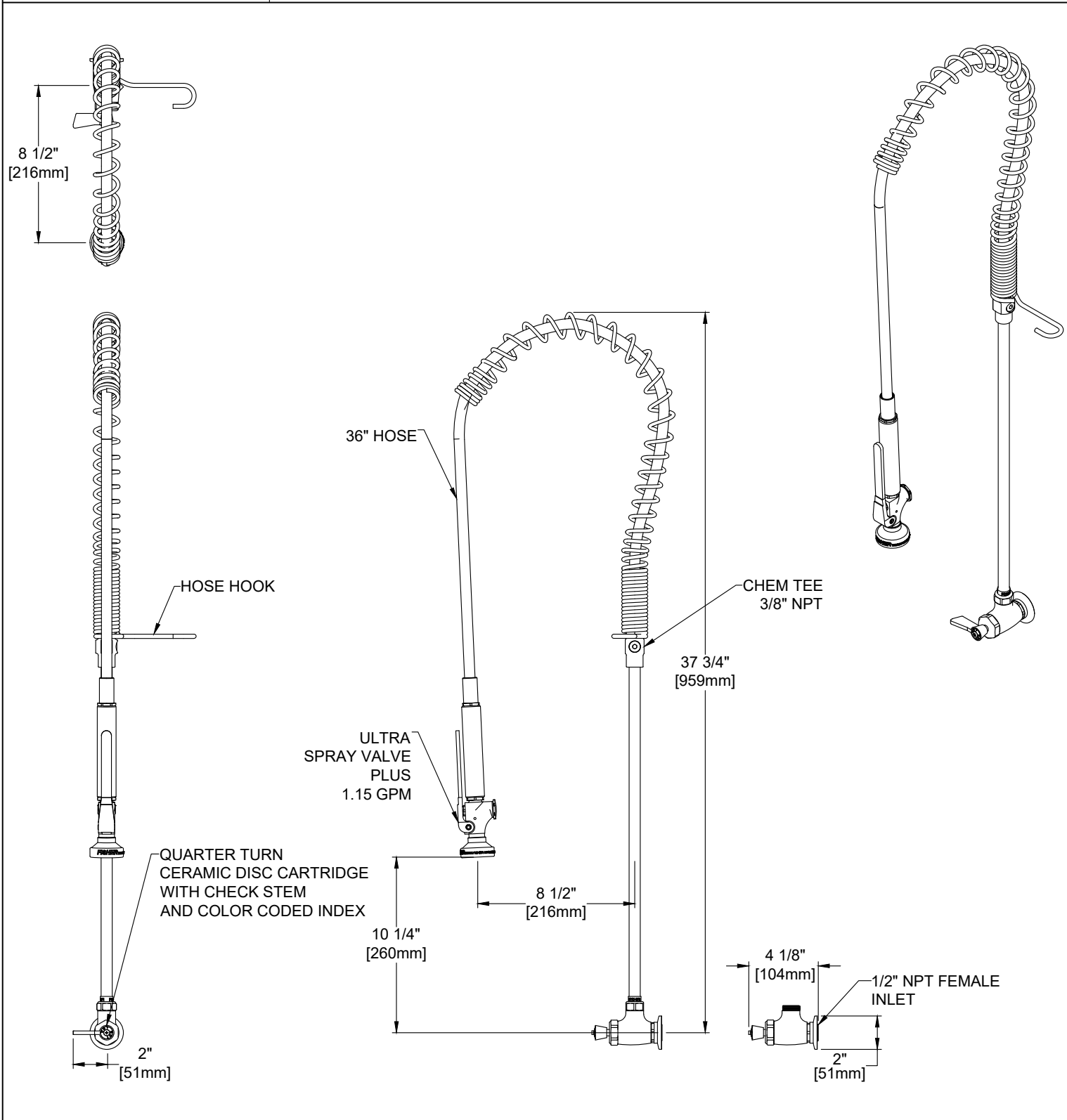

PRODUCT SPECIFICATIONS: PRE-RINSE UNIT: SINGLE WALL CONTROL MOUNT MIXING FAUCET, QUARTER TURN CERAMIC DISC CARTRIDGE W/CHECK STEM, LEVER HANDLE, 36" FLEXIBLE STAINLESS STEEL HOSE, 1.15 GPM SPRAY VALVE, 12" WALL BRACKET, 1/2" NPT FEMALE INLET		PRODUCT COMPLIANCE: ASME A112.18.1 / CSA B125.1 NSF 61 - Section 9 NSF 372 (Low Lead Content) 2019 DOE PRSV - Class II	
Drawn: LC	Checked: EM	Approved: LC	Date: 02/15/24
Sheet:			1 of 2

Customer/Wholesaler:	Date:	Job Name:	Model Specified: 27100	Quantity:
Contractor:		Architect/Engineer:		

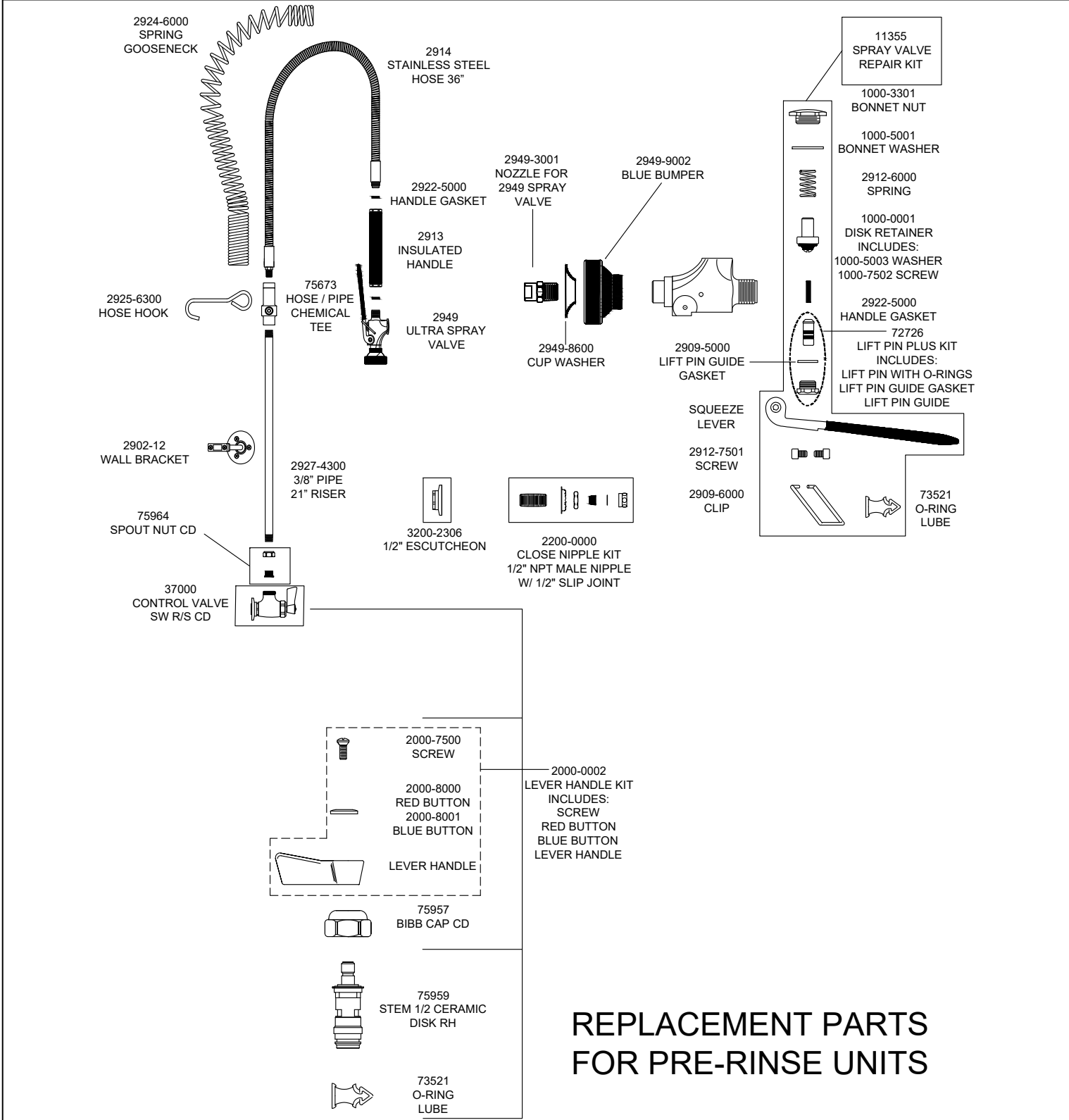

REPLACEMENT PARTS FOR PRE-RINSE UNITS

PRODUCT SPECIFICATIONS: PRE-RINSE UNIT: SINGLE WALL CONTROL MOUNT MIXING FAUCET, QUARTER TURN CERAMIC DISC CARTRIDGE W/CHECK STEM, LEVER HANDLE, 36" FLEXIBLE STAINLESS STEEL HOSE, 1.15 GPM SPRAY VALVE, 12" WALL BRACKET, 1/2" NPT FEMALE INLET		PRODUCT COMPLIANCE: ASME A112.18.1 / CSA B125.1 NSF 61 - Section 9 NSF 372 (Low Lead Content) 2019 DOE PRSV - Class II	
Drawn: LC	Checked: EM	Approved: LC	Date: 02/15/24
Sheet: 2 of 2			