

| | | | | |
|----------------------|-------|---------------------|------------------------|-----------|
| Customer/Wholesaler: | Date: | Job Name: | Model Specified: 20100 | Quantity: |
| Contractor: | | Architect/Engineer: | | |

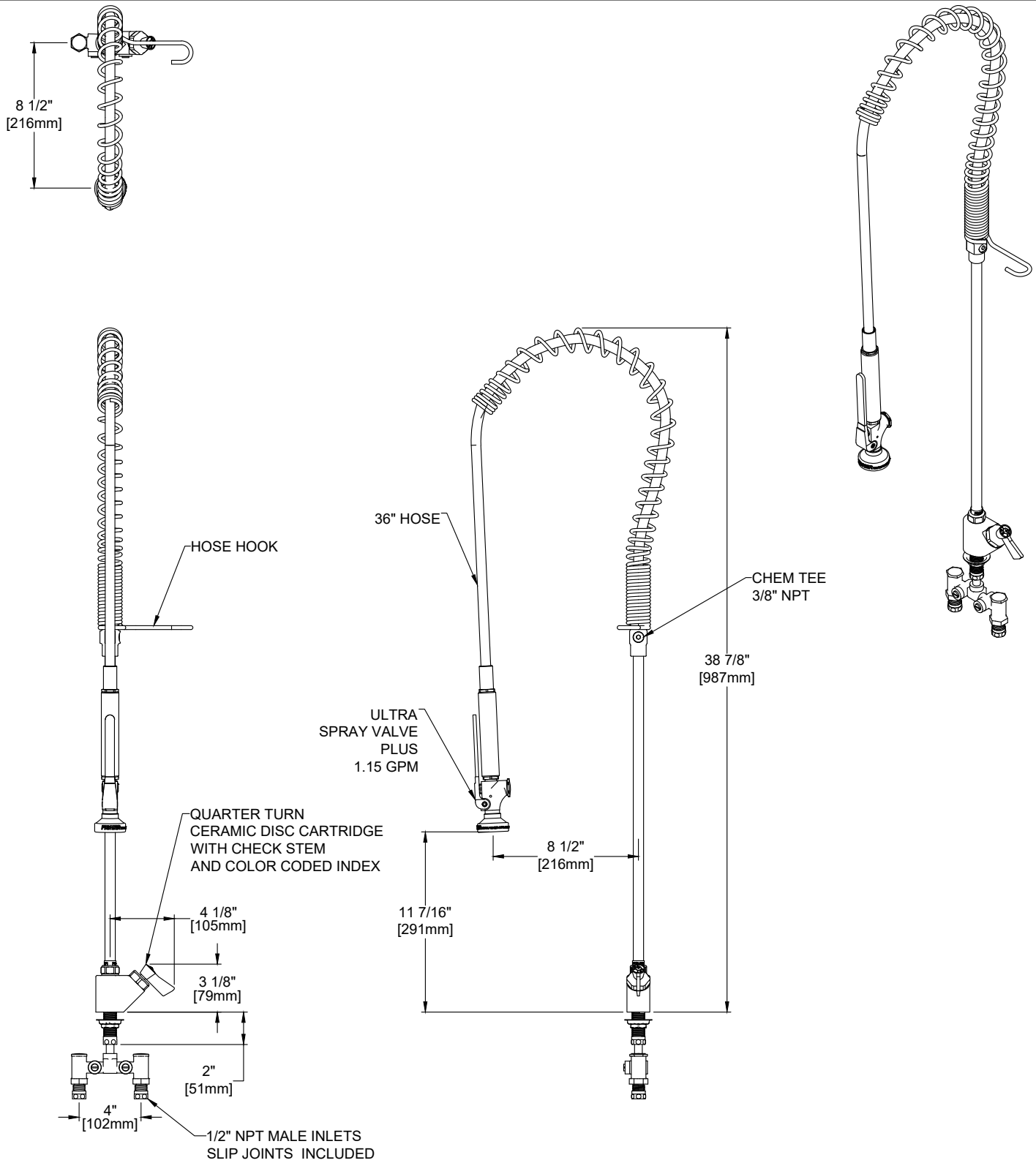

PRODUCT SPECIFICATIONS:
 PRE-RINSE UNIT: SINGLE DECK CONTROL MOUNT MIXING FAUCET, QUARTER TURN CERAMIC DISC CARTRIDGE W/CHECK STEM, LEVER HANDLE, 36" FLEXIBLE STAINLESS STEEL HOSE, 1.15 GPM SPRAY VALVE, 12" WALL BRACKET, 1/2" NPT MALE INLETS SLIP JOINTS INCLUDED

PRODUCT COMPLIANCE:
 ASME A112.18.1 / CSA B125.1
 NSF 61 - Section 9
 NSF 372 (Low Lead Content)
 2019 DOE PRSV - Class II

| | | | | |
|----------------------|-------|---------------------|------------------------|-----------|
| Customer/Wholesaler: | Date: | Job Name: | Model Specified: 20100 | Quantity: |
| Contractor: | | Architect/Engineer: | | |

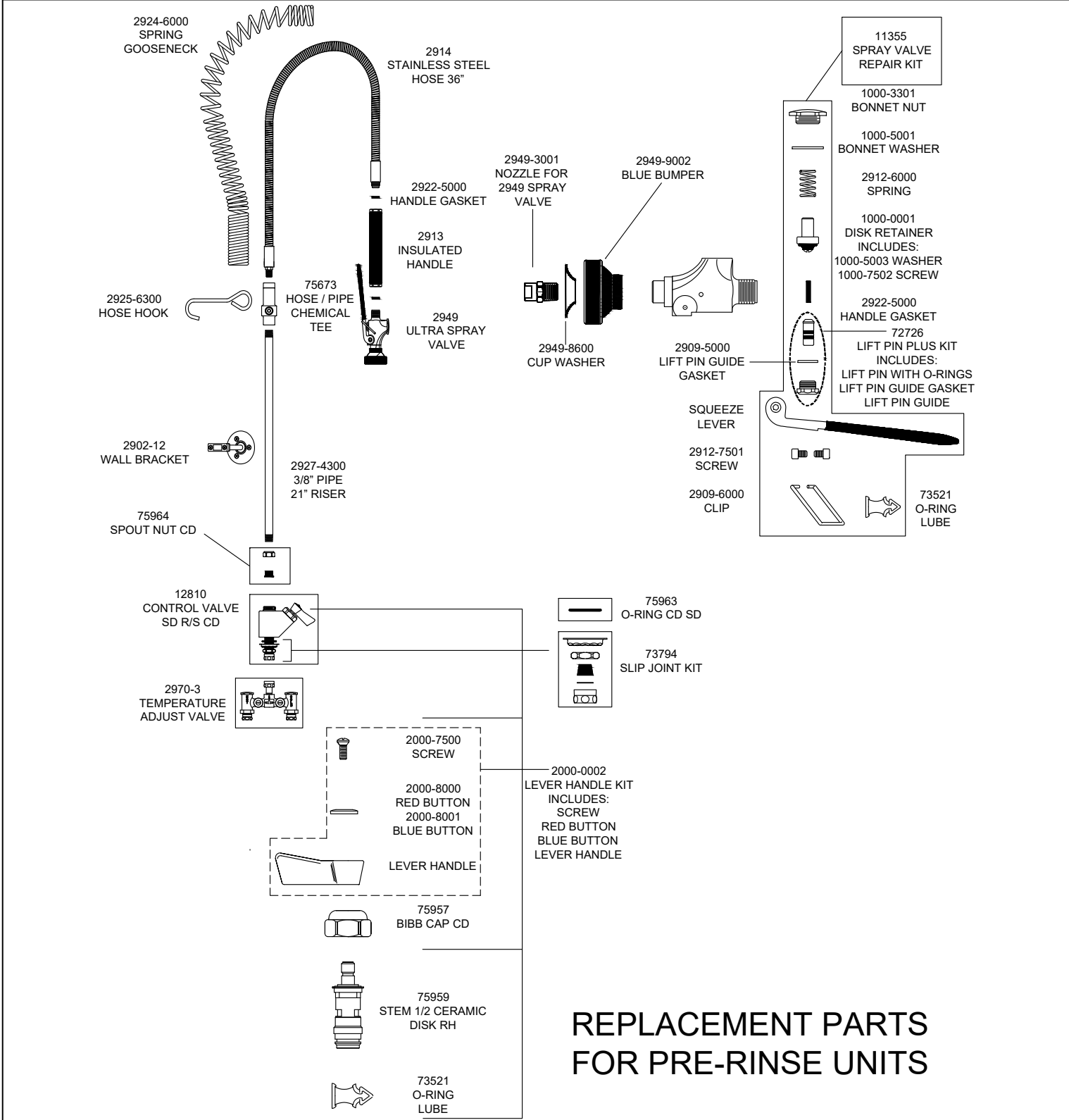

PRODUCT SPECIFICATIONS:
 PRE-RINSE UNIT: SINGLE DECK CONTROL MOUNT MIXING FAUCET, QUARTER TURN CERAMIC DISC CARTRIDGE W/CHECK STEM, LEVER HANDLE, 36" FLEXIBLE STAINLESS STEEL HOSE, 1.15 GPM SPRAY VALVE, 12" WALL BRACKET, 1/2" NPT MALE INLETS SLIP JOINTS INCLUDED

PRODUCT COMPLIANCE:
 ASME A112.18.1 / CSA B125.1
 NSF 61 - Section 9
 NSF 372 (Low Lead Content)
 2019 DOE PRSV - Class II