

Customer/Wholesaler:	Date:	Job Name:	Model Specified: 64790	Quantity:
Contractor:		Architect/Engineer:		

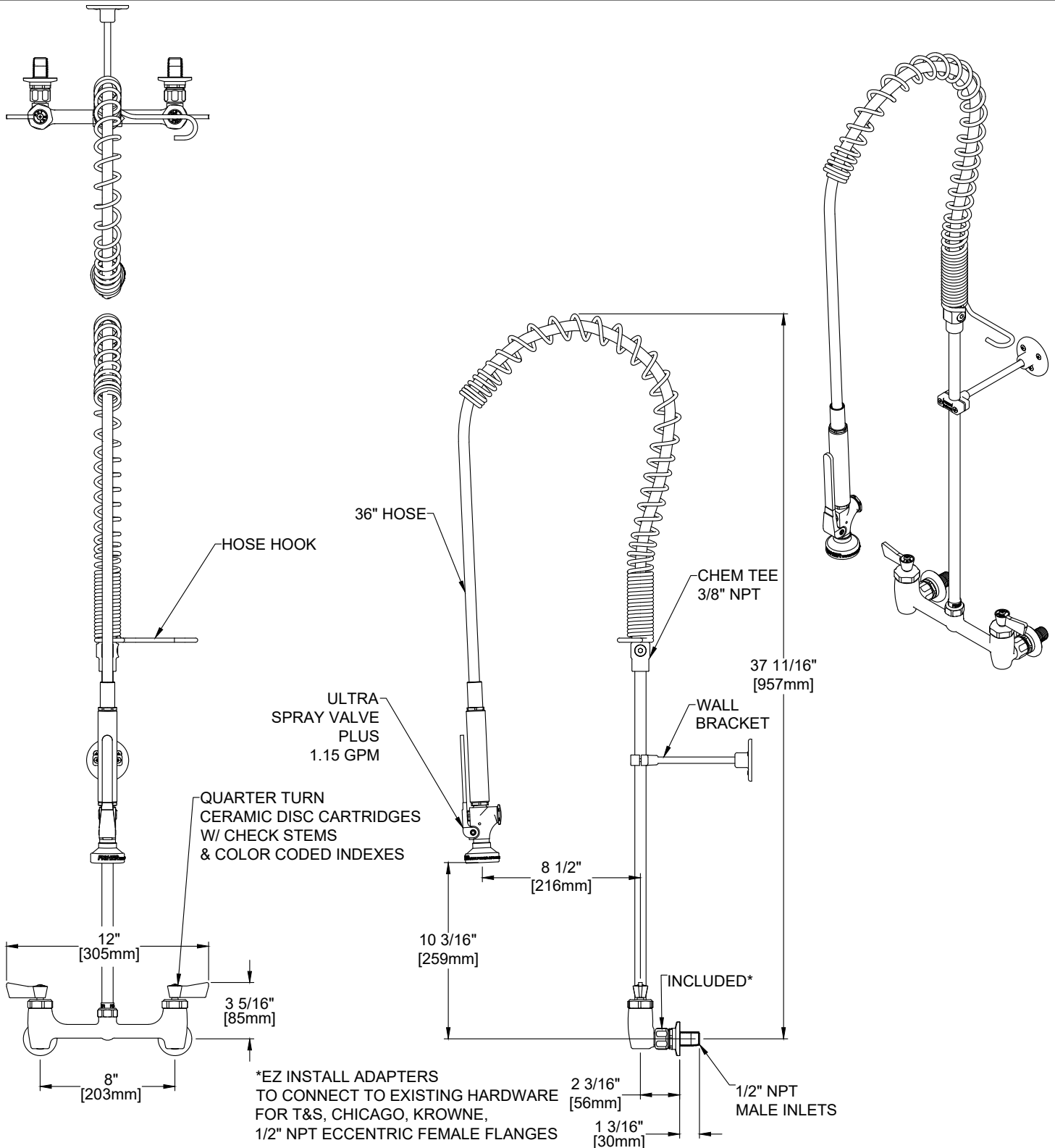

PRODUCT SPECIFICATIONS:
 PRE-RINSE UNIT: 8" BACKSPLASH MOUNT MIXING FAUCET, QUARTER TURN CERAMIC DISC CARTRIDGES W/CHECK STEMS, LEVER HANDLES, 36" FLEXIBLE STAINLESS STEEL HOSE, 1.15 GPM SPRAY VALVE, 12" WALL BRACKET, 1/2" NPT MALE INLETS, INCLUDES EZ INSTALL ADAPTERS

PRODUCT COMPLIANCE:
 ASME A112.18.1 / CSA B125.1
 NSF 61 - Section 9
 NSF 372 (Low Lead Content)
 2019 DOE PRSV - Class II

Customer/Wholesaler:	Date:	Job Name:	Model Specified: 64790	Quantity:
Contractor:		Architect/Engineer:		

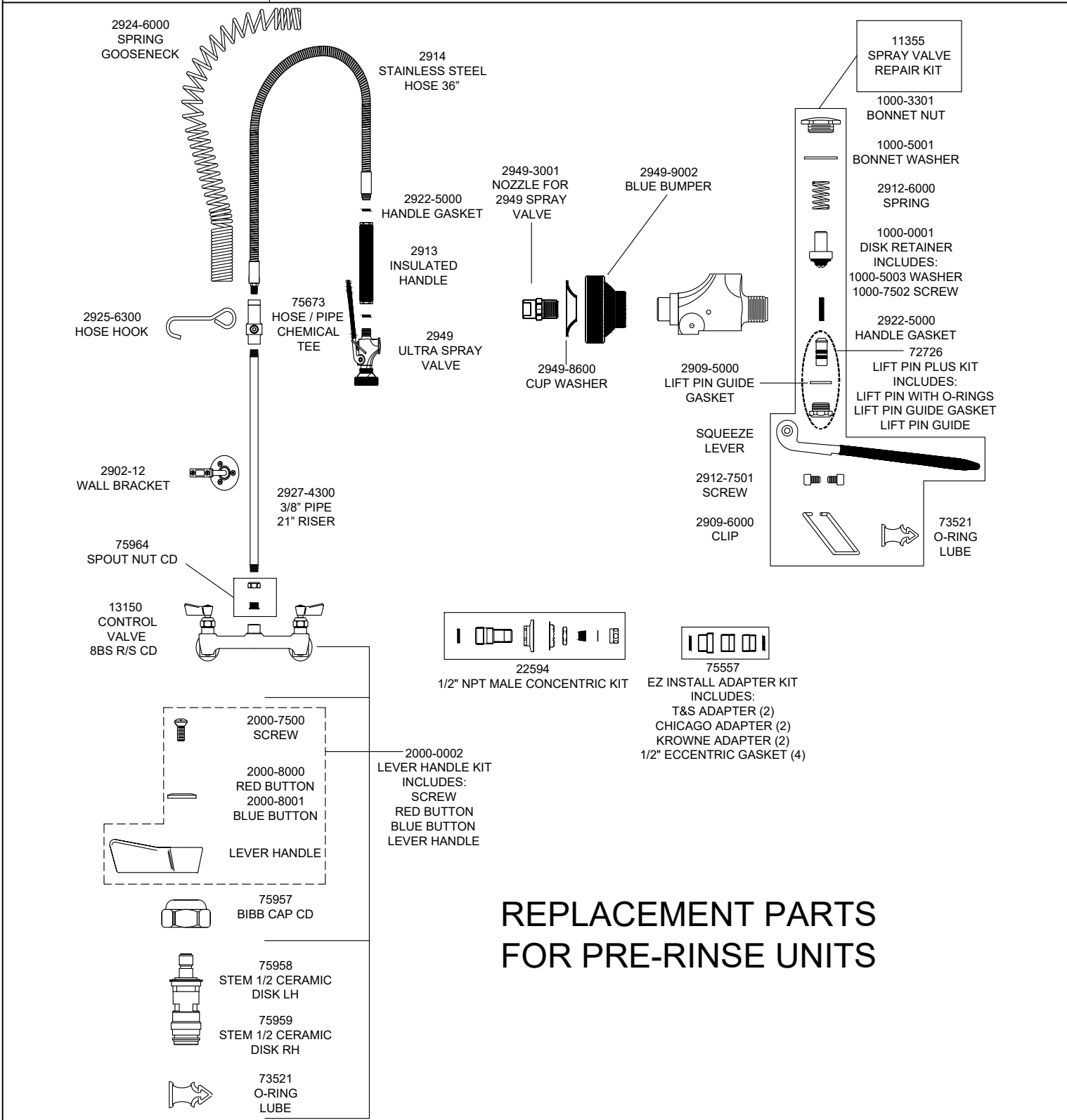

REPLACEMENT PARTS FOR PRE-RINSE UNITS

PRODUCT SPECIFICATIONS: PRE-RINSE UNIT: 8" BACKSPASH MOUNT MIXING FAUCET, QUARTER TURN CERAMIC DISC CARTRIDGES W/CHECK STEMS, LEVER HANDLES, 36" FLEXIBLE STAINLESS STEEL HOSE, 1.15 GPM SPRAY VALVE, 12" WALL BRACKET, 1/2" NPT MALE INLETS, INCLUDES EZ INSTALL ADAPTERS		PRODUCT COMPLIANCE: ASME A112.18.1 / CSA B125.1 NSF 61 - Section 9 NSF 372 (Low Lead Content) 2019 DOE PRSV - Class II	
Drawn: LC	Checked: EM	Approved: LC	Date: 03/27/24
Sheet:			2 of 2