

FISHER[®]

FISHER MANUFACTURING COMPANY TOLL FREE: 800-421-6162 - FAX: 800-832-8238
customer@fisherfaucets.com - www.fisherfaucets.com

PRODUCT NAME:

PRERINSE SPG 8AWCDLH

SPEC. PRCB-SP-8AWLL

Customer/Wholesaler:	Date:	Job Name:	Model Specified: 22100	Quantity:
Contractor:		Architect/Engineer:		

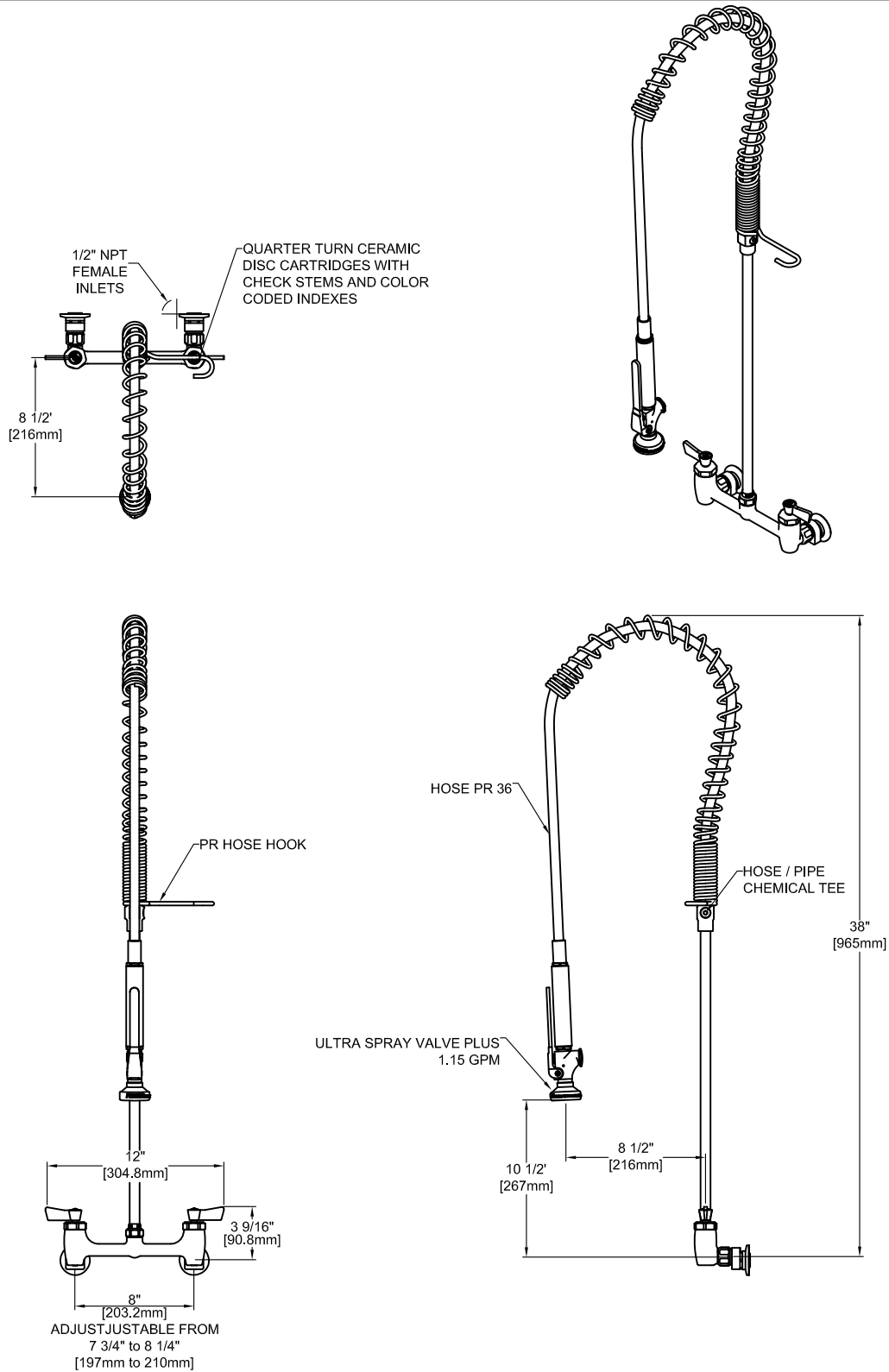

PRODUCT SPECIFICATIONS:
Pre-Rinse Unit: 8" Wall Mount Mixing Faucet, Quarter Turn Ceramic Cartridges w/ Spring Checks, Lever Handles, 36" Flexible Stainless Steel Hose, 1.15 GPM Spray Valve, 6" Wall Bracket & 1/2" NPT Female Inlets

PRODUCT COMPLIANCE:
ASME A112.18.1 / CSA B125.1
NSF 61 - Section 9
NSF 372 (Low Lead Content)
2019 DOE PRSV - Class II

Drawn: DF	Checked: EM	Approved: DF	Date: 02/09/24	Sheet: 1 of 2
-----------	-------------	--------------	----------------	---------------

Customer/Wholesaler:	Date:	Job Name:	Model Specified: 22100	Quantity:
Contractor:		Architect/Engineer:		

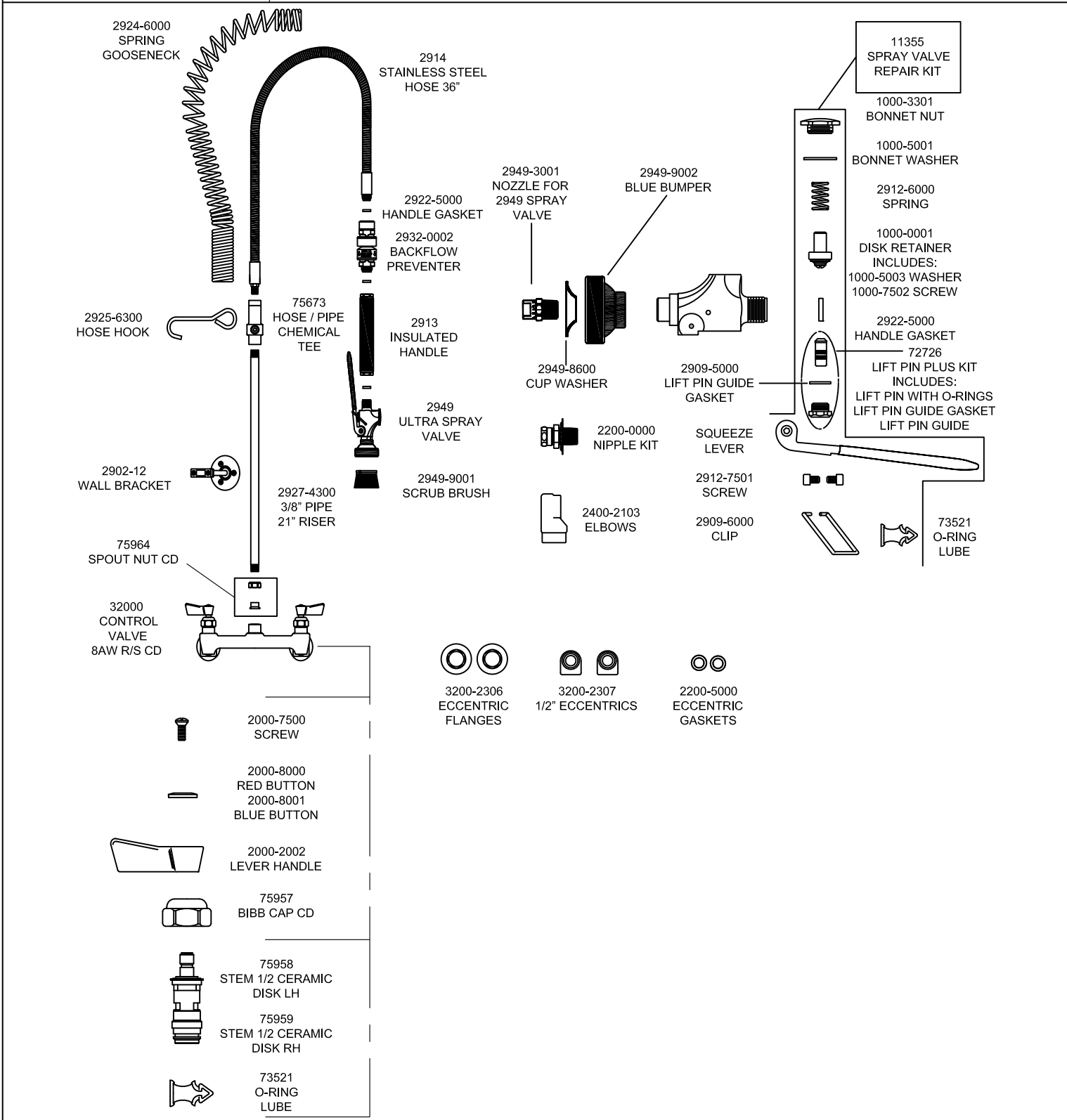

PRODUCT SPECIFICATIONS: Pre-Rinse Unit: 8" Wall Mount Mixing Faucet, Quarter Turn Ceramic Cartridges w/ Spring Checks, Lever Handles, 36" Flexible Stainless Steel Hose, 1.15 GPM Spray Valve, 6" Wall Bracket & 1/2" NPT Female Inlets		PRODUCT COMPLIANCE: ASME A112.18.1 / CSA B125.1 NSF 61 - Section 9 NSF 372 (Low Lead Content)	
Drawn: DF	Checked: EM	Approved: DF	Date: 02/09/24
Sheet:		2 of 2	