

Customer/Wholesaler:	Date:	Job Name:	Model Specified:	Quantity:
Contractor:		Architect/Engineer:		

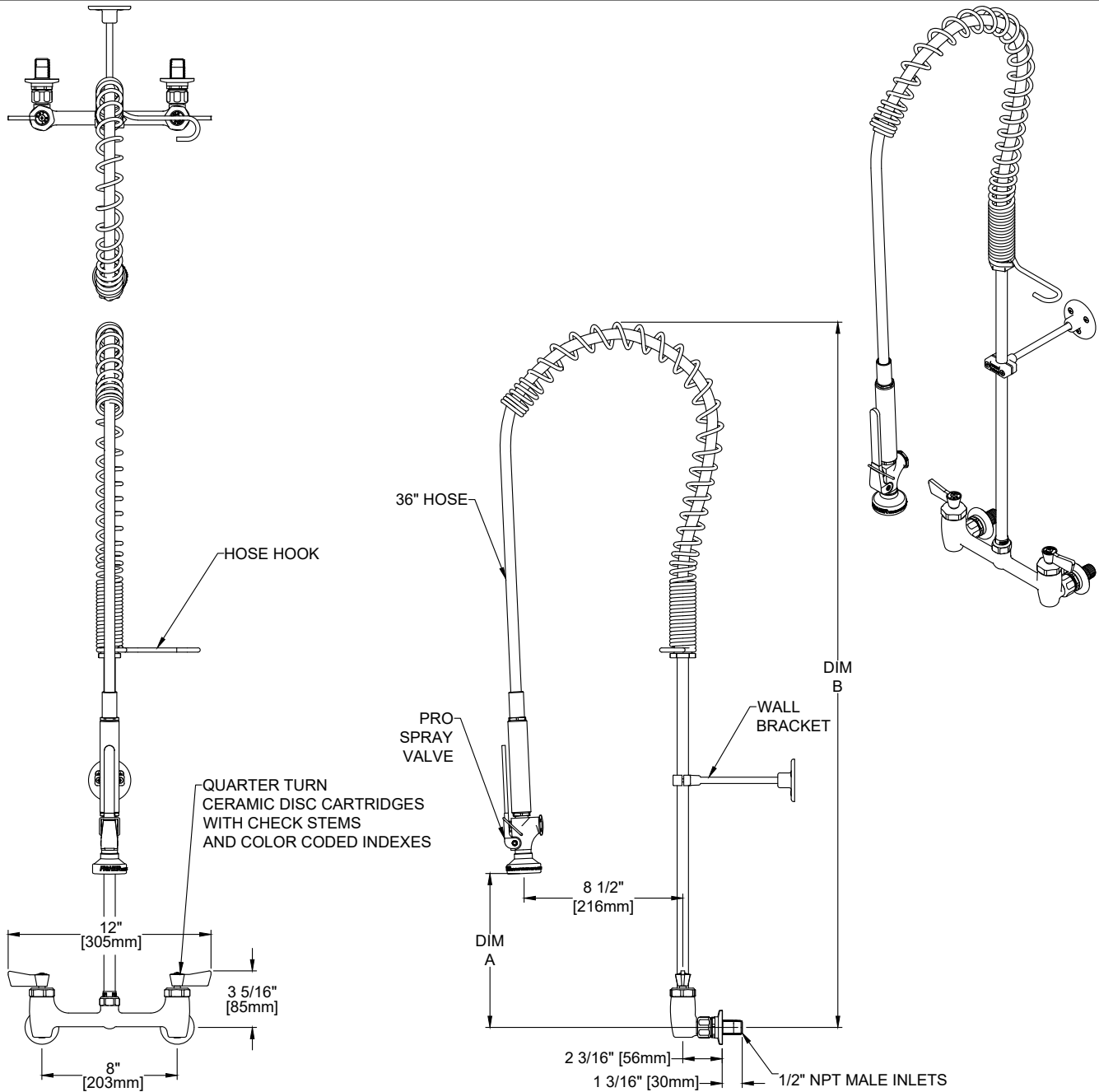

MODEL	DESCRIPTION	DIM A	DIM B
<input type="checkbox"/> 13380	PRERINSE SPG 8BSCDLH INTERNATIONAL SALES ONLY	8 7/8" [225mm]	36 5/16" [922mm]
<input type="checkbox"/> 73120	PRERINSE SPG 8BSCDLH 16R INTL	3 3/16" [81mm]	30 5/8" [778mm]

<p>PRODUCT SPECIFICATIONS: PRE-RINSE UNIT: 8" BACKSPLASH MOUNT MIXING FAUCET, QUARTER TURN CERAMIC DISC CARTRIDGES W/CHECK STEMS, LEVER HANDLES, 36" FLEXIBLE STAINLESS STEEL HOSE, 2.65 GPM @ 80 PSI SPRAY VALVE, 12" WALL BRACKET, 1/2" NPT MALE INLETS</p>	<p>PRODUCT COMPLIANCE: ASME A112.18.1 / CSA B125.1 NSF 61 - Section 9 NSF 372 (Low Lead Content)</p>
---	--

Customer/Wholesaler:	Date:	Job Name:	Model Specified:	Quantity:
Contractor:		Architect/Engineer:		

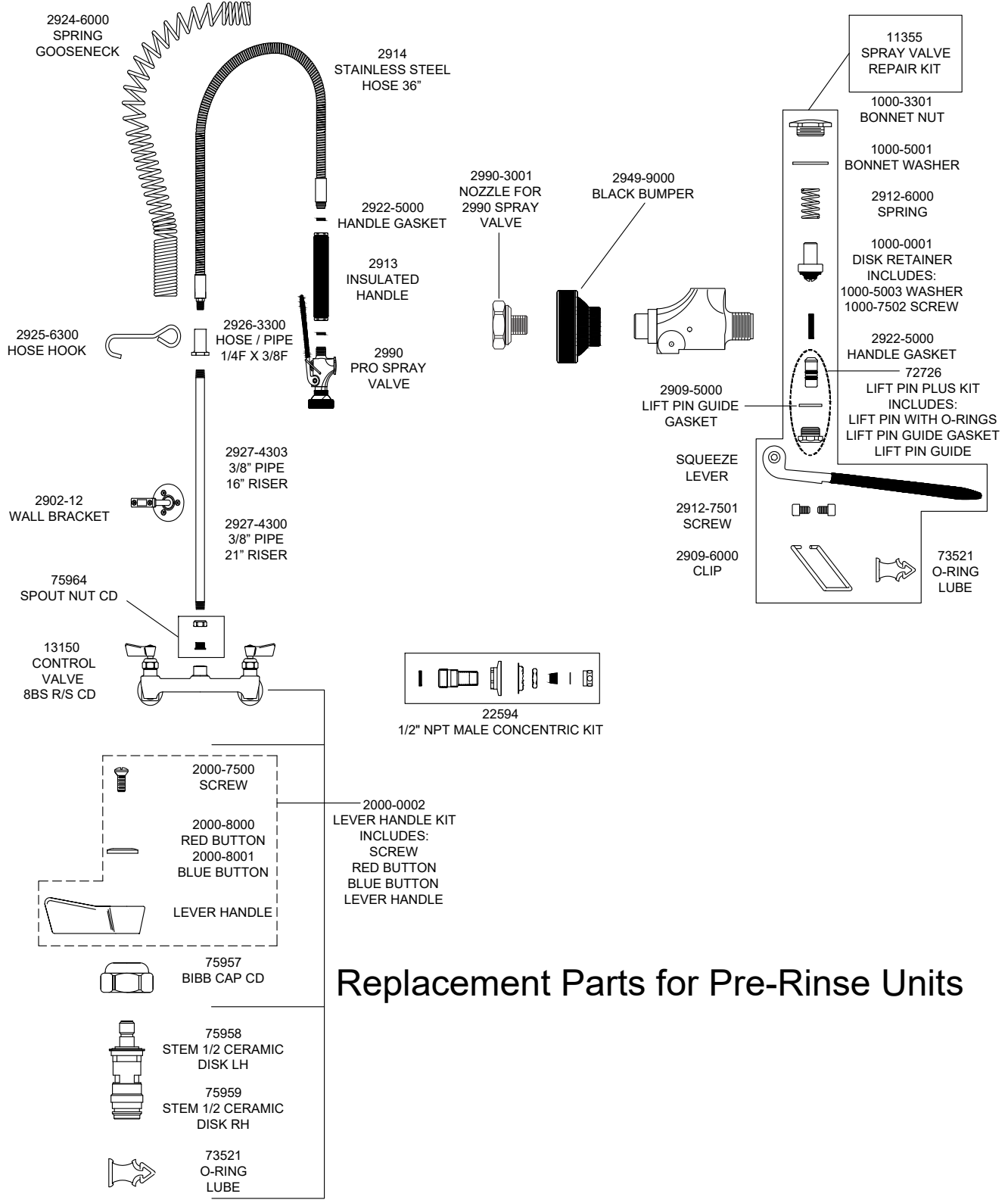

Replacement Parts for Pre-Rinse Units

PRODUCT SPECIFICATIONS: PRE-RINSE UNIT: 8" BACKSPASH MOUNT MIXING FAUCET, QUARTER TURN CERAMIC DISC CARTRIDGES W/CHECK STEMS, LEVER HANDLES, 36" FLEXIBLE STAINLESS STEEL HOSE, 2.65 GPM @ 80 PSI SPRAY VALVE, 12" WALL BRACKET, 1/2" NPT MALE INLETS	PRODUCT COMPLIANCE: ASME A112.18.1 / CSA B125.1 NSF 61 - Section 9 NSF 372 (Low Lead Content)
---	---