

PRODUCT NAME:

3/4 FAUCET SINGLE WALL
WITH CONTROL SPOUT & DJ

SPEC. FATB-PFDJ-SWX

Customer/Wholesaler:	Date:	Job Name:	Model Specified:	Quantity:
Contractor:	Architect/Engineer:			

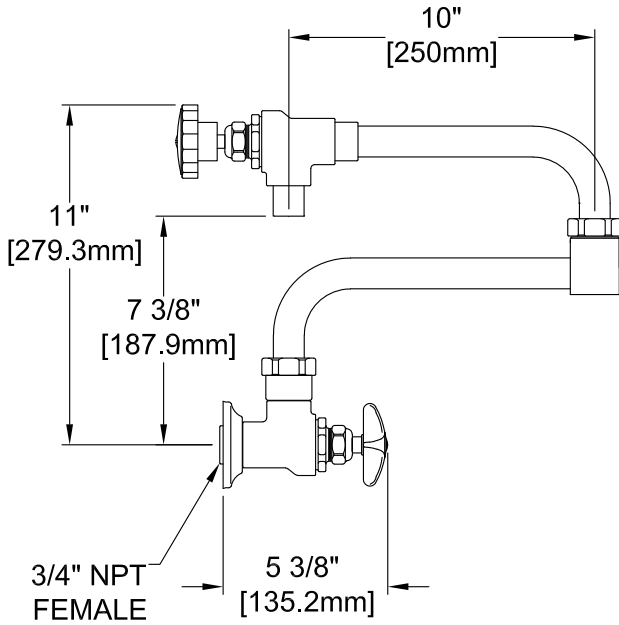

MODEL:

5730 3/4 FAUCET SWXH 10CS10DJ

OPTIONS OR MODIFICATIONS:

OTHER _____

FEATURES:

- * SINGLE WALL
- * SWIVELLING SEAT DISKS
- * STEM - RIGHT HAND
- * STAINLESS STEEL SEATS
- * STAINLESS STEEL SEAT SCREWS
- * STAINLESS STEEL HANDLE SCREWS
- * HOT & COLD INDEX BUTTONS

SYSTEM LIMITS

- * TEMP: 40°F MIN. TO 160°F MAX.
- * PRESSURE 200 PSI MAX. STATIC
- * 29 GPM AT 80 PSI (109.7 L/min @550 KPa)

SHIPPING WEIGHT

- * 8.5 LBS

PRODUCT COMPLIANCE:

- * ASME A112.18.1 / CSA B125.1
- * NSF 61 - Section 9
- * NSF 372 (Low Lead Content)

ROUGH-IN:

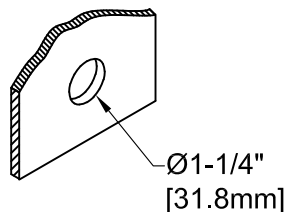

Replacement Parts for 3/4" Single Wall Faucets

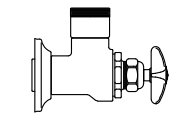

5700
CONTROL VALVE



2000-7500
SCREW



2000-8000
RED BUTTON
AND
2000-8001
BLUE BUTTON

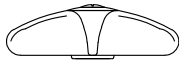

CROSS HANDLE



2000-3002
BIBB CAP



73657
DUCK GASKET



2000-5000
WASHER

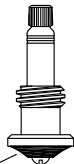

5000-0007
RH SWIVEL
STEM

73550
SEAT WASHER

1000-7502
SCREW



73521
LUBE

5071
10" CONTROL
SWING
SPOUT

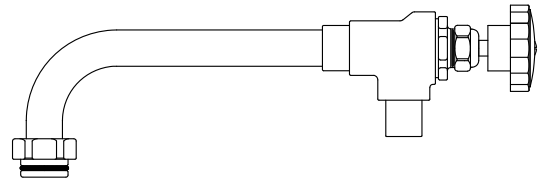

3983
CROSS HANDLE KIT

5000-0003
10" DJ SPOUT

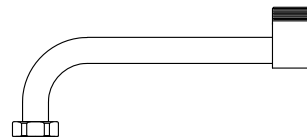

5000-0010
RH SWIVEL
STEM REPAIR
KIT