



FISHER MANUFACTURING COMPANY TOLL FREE: 800-421-6162 - FAX: 800-832-8238
customer@fisher-mfg.com - www.fisher-mfg.com

PRODUCT NAME:

FAUCET SINGLE BASE DECK
& SWING SPOUT

SPEC. FAHB-KF-BD

Customer/Wholesaler:

Date:

Job Name:

Model Specified:

Quantity:

Contractor:

Architect/Engineer:

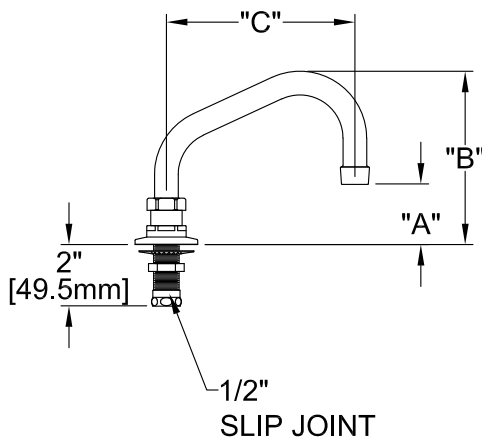

FOOTPRINT:

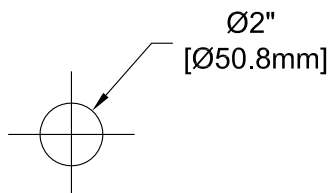

MODEL	DIM "A"	DIM "B"	DIM "C"
3810	1-3/4" [44.4mm]	5-3/8" [136.5mm]	6" [152.4mm]
3811	2" [50.8mm]	5-7/8" [149.2mm]	8" [203.2mm]
3812	2-5/8" [66.7mm]	6-3/8" [161.9mm]	10" [254.0mm]
3813	3-1/4" [82.6mm]	6-7/8" [174.6mm]	12" [304.8mm]
3814	3-7/8" [98.4mm]	7-3/4" [196.9mm]	14" [355.6mm]
1678	4-5/8" [117.5mm]	8-3/8" [212.7mm]	16" [406.4mm]

MODEL:

- ☐ 3810 FAUCET BD 06SS
- ☐ 3811 FAUCET BD 08SS
- ☐ 3812 FAUCET BD 10SS
- ☐ 3813 FAUCET BD 12SS
- ☐ 3814 FAUCET BD 14SS
- ☐ 1678 FAUCET BD 16SS

OPTIONS OR MODIFICATIONS:

- ☐ OTHER _____

FEATURES:

- * SINGLE BASE DECK
- * SWING SPOUT
- * 1/2" SLIP JOINT

SYSTEM LIMITS

- * TEMP: 40°F MIN. TO 160°F MAX.
- * PRESSURE 200 PSI MAX. STATIC
- * 2.20 GPM AT 60 PSI (8.3L/min @ 410 kPa)

SHIPPING WEIGHT

- * 2.0 LBS

PRODUCT COMPLIANCE:

- * ASME A112.18.1 / CSA B125.1
- * NSF 61 - Section 9
- * NSF 372 (Low Lead Content)

ROUGH-IN:

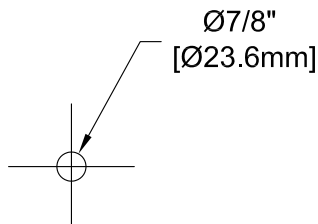

Drawn: DF

Checked: EM

Approved: DF

Date: 11/23/20

Sheet:

1 of 2

Replacement Parts for Single Base Deck Mount Faucets



3800
BASE DECK

73794
SLIP JOINT KIT



3967
16" SWING SPOUT

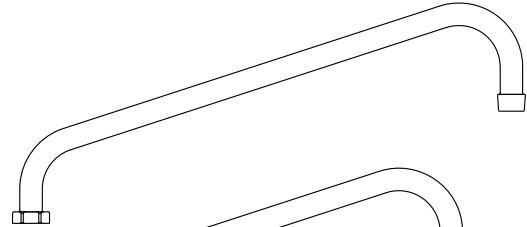

3964
14" SWING SPOUT

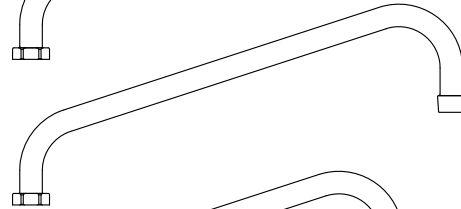

3963
12" SWING SPOUT

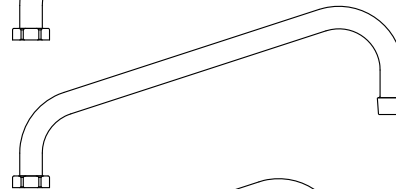

3962
10" SWING SPOUT

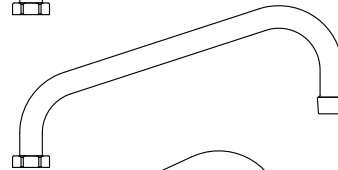

3961
8" SWING SPOUT

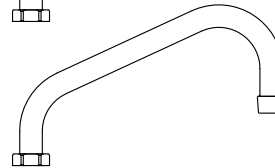

3960
6" SWING SPOUT

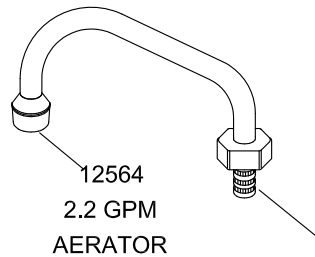
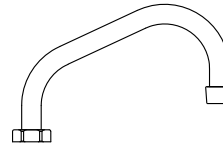

12564
2.2 GPM
AERATOR

73684
SPOUT NUT



20020
SNAP RING



1600-5000
SPOUT
O-RING



73521
LUBE



19119
SWIVEL SPOUT
RETRO-FIT KIT