

Customer/Wholesaler:	Date:	Job Name:	Model Specified:	Quantity:
Contractor:		Architect/Engineer:		

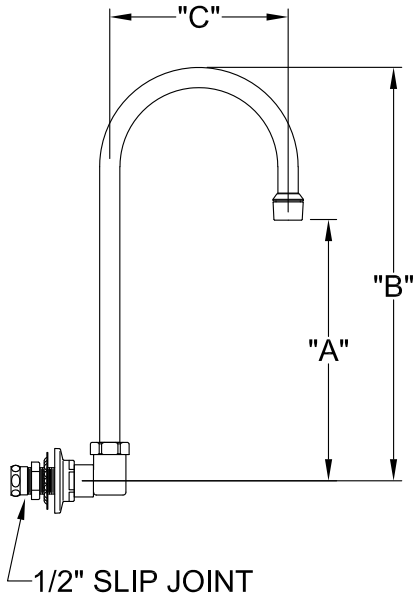

**MODEL:**

- 3915 FAUCET BBS 12SGN
- 2038 FAUCET BBS 06SGN

**OPTIONS OR MODIFICATIONS:**

- OTHER \_\_\_\_\_

**FEATURES:**

- \* SINGLE BACKSPASH BASE
- \* SWING SPOUT
- \* 1/2" SLIP JOINT

**SYSTEM LIMITS**

- \* TEMP: 40°F MIN. TO 160°F MAX.
- \* PRESSURE 200 PSI MAX. STATIC
- \* 2.20 GPM AT 60 PSI (8.3L/min @ 410 kPa)

**SHIPPING WEIGHT**

- \* 3.0 LBS

**PRODUCT COMPLIANCE:**

- \* ASME A112.18.1 / CSA B125.1
- \* NSF 61 - Section 9
- \* NSF 372 (Low Lead Content)

MODEL	DIM "A"	DIM "B"	DIM "C"
3915	6-1/16" [154.0mm]	10-1/8" [257.2mm]	5-1/2" [139.7mm]
2038	4-11/16" [119.1mm]	7-1/8" [181.0mm]	3-1/2" [88.90mm]

**ROUGH-IN:**

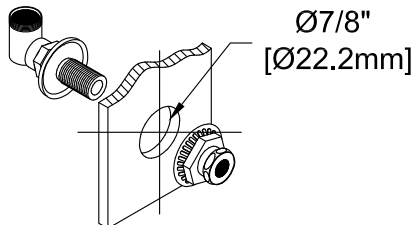

## Replacement Parts for Backsplash Base Mount Faucets

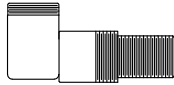

3900  
BACKSPLASH BASE

3968  
6" SWIVEL  
GOOSENECK SPOUT

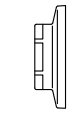
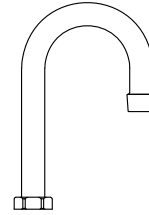

3200-2306  
FLANGE

3965  
12" SWIVEL  
GOOSENECK SPOUT

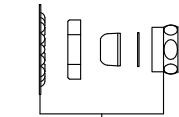
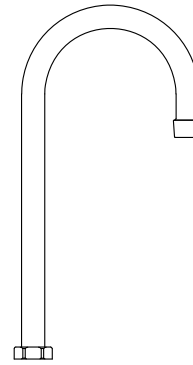

73794  
1/2" SLIP JOINT  
KIT

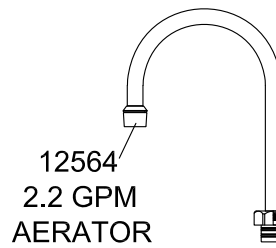

12564  
2.2 GPM  
AERATOR

73684  
SPOUT NUT



20020  
SNAP RING



1600-5000  
SPOUT  
O-RING



73521  
LUBE



19119  
SWIVEL SPOUT  
RETRO-FIT KIT