

FISHER[®]

FISHER MANUFACTURING COMPANY TOLL FREE: 800-421-6162 - FAX: 800-832-8238
customer@fisherfaucets.com - www.fisherfaucets.com

PRODUCT NAME:

CONTROL VALVE CHCDLH R/S

Customer/Wholesaler:

Date:

Job Name:

Model Specified: 15010

Quantity:

Contractor:

Architect/Engineer:

SPEC. CV/CB-SO-CHL

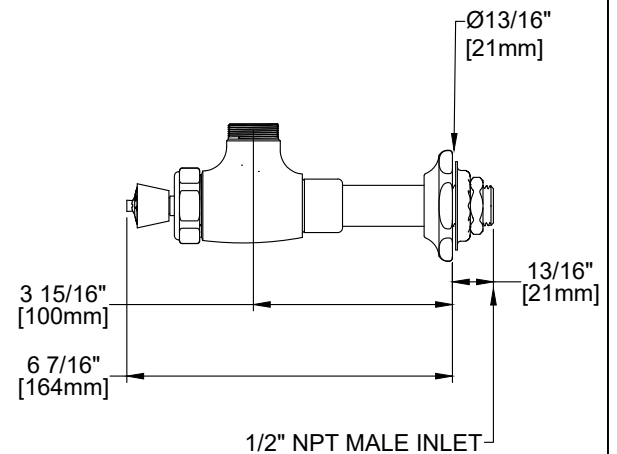
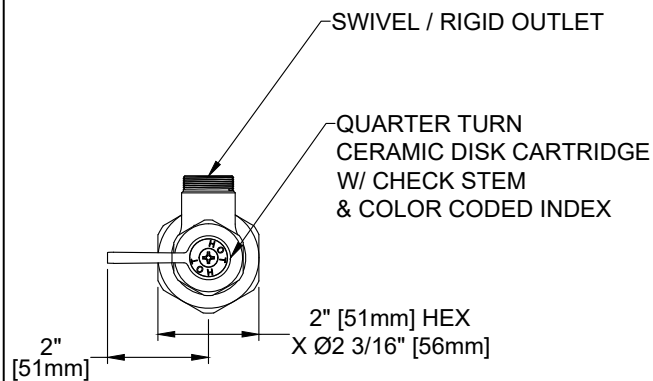
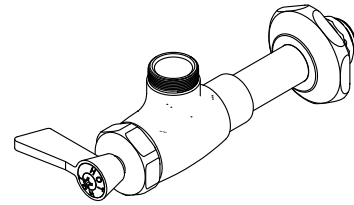
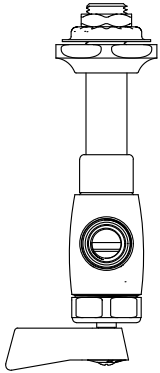

PRODUCT SPECIFICATIONS: CHINESE RANGE CONTROL VALVE, 1/2" X 3 5/8" NIPPLE, QUARTER TURN CERAMIC DISK CARTRIDGE W/ CHECK STEM, LEVER HANDLE, 1/2" NPT MALE INLET

PRODUCT COMPLIANCE:
ASME A112.18.1 / CSA B125.1
NSF 61 - Section 9
NSF 372 (Low Lead Content)

Drawn: LC

Checked: EM

Approved: LC

Date: 12/19/24

Sheet: 1 of 2



FISHER MANUFACTURING COMPANY TOLL FREE: 800-421-6162 - FAX: 800-832-8238
customer@fisherfaucets.com - www.fisherfaucets.com

PRODUCT NAME:
CONTROL VALVE CHCDLH R/S

SPEC. CV/CB-SO-CHL

Customer/Wholesaler:	Date:	Job Name:	Model Specified: 15010	Quantity:
Contractor:	Architect/Engineer:			

REPLACEMENT PARTS

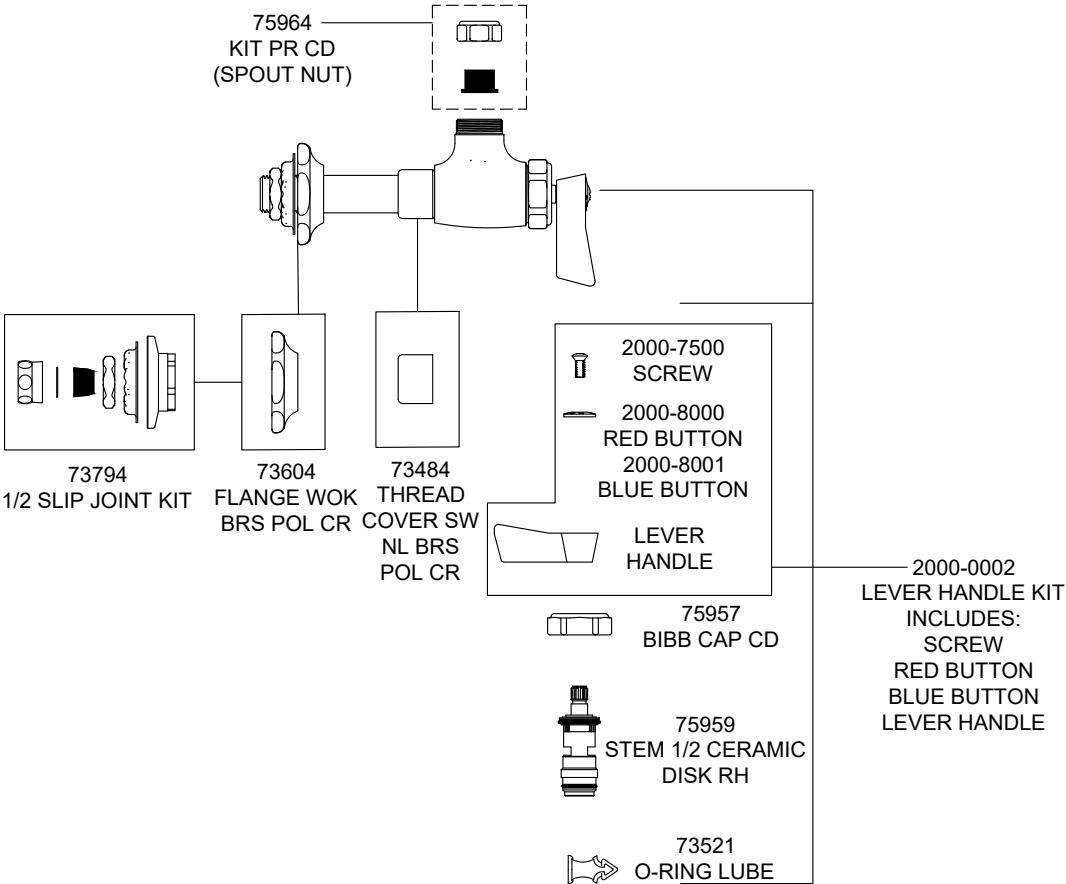

PRODUCT SPECIFICATIONS: CHINESE RANGE CONTROL VALVE, 1/2" X 3 5/8" NIPPLE, QUARTER TURN CERAMIC DISK CARTRIDGE W/ CHECK STEM, LEVER HANDLE, 1/2" NPT MALE INLET			PRODUCT COMPLIANCE: ASME A112.18.1 / CSA B125.1 NSF 61 - Section 9 NSF 372 (Low Lead Content)	
--	--	--	--	--

Drawn: LC	Checked: EM	Approved: LC	Date: 12/19/24	Sheet: 2 of 2
-----------	-------------	--------------	----------------	---------------