

Other Replacement Parts

1/2" Swing Spouts

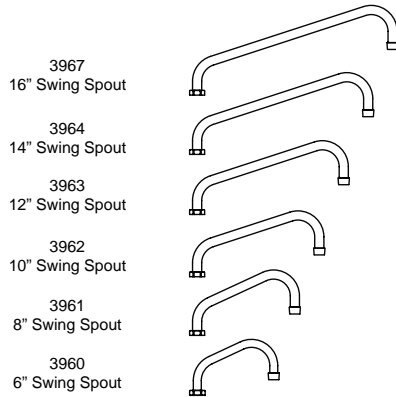

1/2" Swivel Goosneck Spouts

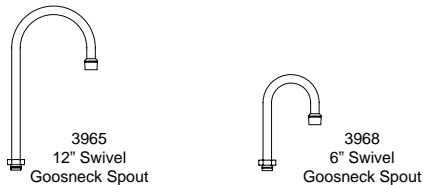

Swing Spout Retro Fit Kit Product Installation Guide

Since 1936, Fisher Manufacturing Company has manufactured heavy-duty, high quality plumbing products and hardware specialties for the food service industry. For three generations, the Fisher family has adhered to a strict dedication of and overall value. When you install Fisher products... you install the best. Our hardware is manufactured with the standardization of internal mechanisms. All chrome plating is triple plated copper, nickel and chrome for durability. Every piece of equipment we make is rigorously tested in both our modern in-house testing center and in actual field situations under extreme conditions. Every detail is thoroughly checked. Before we make our products available to you, they pass each and every test. You get proven performance. Guaranteed.

Limited One Year Warranty

Fisher Manufacturing Company warrants its products and parts thereof (except as noted below) against defects in materials or workmanship for a period of one year after the date of original purchase. During this period Fisher Manufacturing Company will replace a defective product or part without charge to you, provided that the entire product is delivered to Fisher Manufacturing Company. All transportation and insurance charges for shipping the product to and from Fisher Manufacturing Company must be borne by you. Charges for transportation and insurance may, at the option of Fisher Manufacturing Company, be refunded depending upon our investigation of the warranty claim. This warranty does not cover external finish (except at date of original purchase) or labor costs not specifically authorized by Fisher Manufacturing Company.

A full and complete copy of our One Year limited warranty is available upon request.

WARNING:

Proposition 65 requires that we provide you with the following notice: "This product Contains A Chemical Known To The State Of California To Cause Birth Defects Or Other Reproductive Harm."

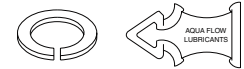

19119 - Swing spout retro fit kit

KEEP THIS MANUAL FOR FUTURE REFERENCE



ANSI/A112.18.1M, ANSI/NSF 61.9

FISHER MANUFACTURING COMPANY - TOLL FREE: 800-421-6162 FAX: 800-832-8238

BE SURE TO CHECK WITH YOUR LOCAL DEPARTMENT HAVING JURISDICTION REGARDING BACKFLOW PREVENTION

Installation Notes:

- Be sure to shut off water supply before beginning.
- Use pipe thread sealant such as PST on all threaded joints.
- Check the packaging for missing items BEFORE beginning installation. If items are missing, contact your supplier.

Tools Required for Installation

- Medium Sized Crescent Wrench



Package Contents:



Installation Instructions

1. Remove spout from faucet body:
Loosen spout nut with a wrench and pull spout from the faucet body. Remove all existing parts from the spout: o-rings, and snap ring. Discard these parts.
2. Remove the following from the “RETRO FIT” package #19119:
Qty: 2 O-RINGS ① #1600-5000
Qty: 1 SNAP RING ② #2002
Qty: 1 LUBRICATION TUBE ③ #10456
3. Install the kit as follows on the swing spout:
Slide the snap ring onto the spout and move it into the third groove from the bottom. Install one o-ring into each of the remaining grooves.
4. Install spout into faucet body:
Lightly lubricate the inside area of the faucet body where the spout sits. Carefully align the spout with the faucet body so that when the spout slides into the faucet body, it will go in straight and not cause the o-rings to bind and come out of their grooves. Firmly press the spout into the faucet body. Tighten the spout nut firmly with a wrench.

Installation Instructions for Swing Spout Retro Fit Kit

BE SURE TO CHECK WITH YOUR LOCAL DEPARTMENT HAVING JURISDICTION REGARDING BACKFLOW PREVENTION

Installation Notes:

- Be sure to shut off water supply before beginning.
- Use pipe thread sealant such as PST on all threaded joints.
- Check the packaging for missing items BEFORE beginning installation. If items are missing, contact your supplier.

Tools Required for Installation

- Medium Sized Crescent Wrench



Package Contents:



Installation Instructions

1. Remove spout from faucet body:
Loosen spout nut with a wrench and pull spout from the faucet body. Remove all existing parts from the spout: o-rings, and snap ring. Discard these parts.
2. Remove the following from the “RETRO FIT” package #19119:
Qty: 2 O-RINGS ① #1600-5000
Qty: 1 SNAP RING ② #2002
Qty: 1 LUBRICATION TUBE ③ #10456
3. Install the kit as follows on the swing spout:
Slide the snap ring onto the spout and move it into the third groove from the bottom. Install one o-ring into each of the remaining grooves.
4. Install spout into faucet body:
Lightly lubricate the inside area of the faucet body where the spout sits. Carefully align the spout with the faucet body so that when the spout slides into the faucet body, it will go in straight and not cause the o-rings to bind and come out of their grooves. Firmly press the spout into the faucet body. Tighten the spout nut firmly with a wrench.

STEP 1

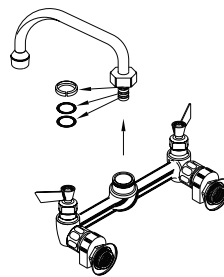

STEP 2

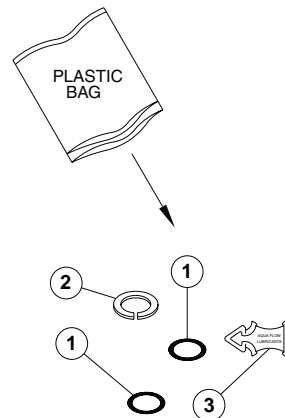

STEP 3

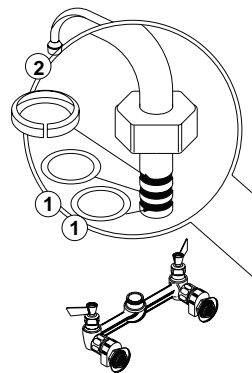

STEP 4

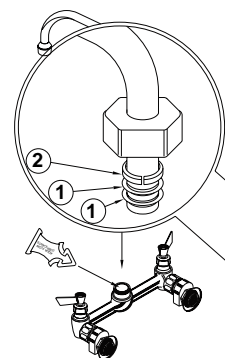

Installation Instructions Continued

STEP 1

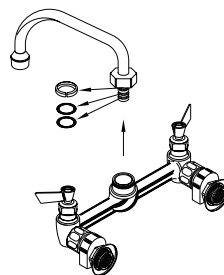

STEP 2

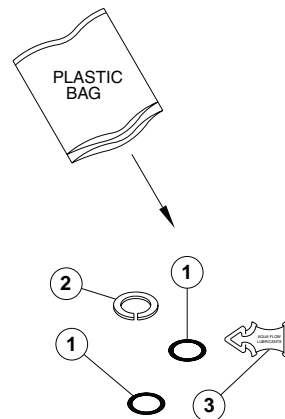

STEP 3

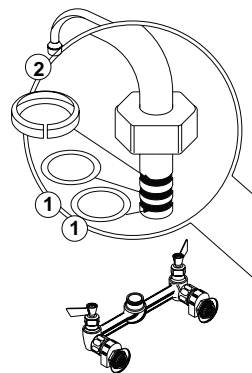

STEP 4

